

WASHINGTON, DC

DESIGN
HOUSE

BENEFITING CHILDREN'S
NATIONAL HEALTH SYSTEM



**Children's
National**TM

October 1–30, 2016
Washington, DC

DCDesignHouse.com

BEST TILE®



Ceramic ♦ Porcelain ♦ Natural Stone ♦ Glass ♦ Metal

See our tile showcased in the 9th Annual DC Design House October 1st - 30th

As the ultimate Mid-Atlantic destination for tile and stone products, Best Tile's professional design services and superior quality will achieve your vision. From trend setting porcelains and vibrant glass mosaics to the most elegant stone designs, Best Tile offers the area's largest selection of American and European products.

 BestTile.com

ROCKVILLE, MD

11601 Boiling Brook Pkwy (301) 984-3399

COLUMBIA, MD

6822 Oak Hall Lane (410) 381-1169

LORTON, VA

8196 Terminal Road (703) 550-2352

RICHMOND, VA

7490 West Broad St. (804) 672-6316

EXCLUSIVE DESIGN | SOLID TEAK CONSTRUCTION | LASTING QUALITY

Experience the Quality First Hand



VISIT OUR SHOWROOM IN GAITHERSBURG, MARYLAND

COUNTRY CASUAL TEAK™
OUTDOOR FURNITURE SINCE 1977

301.926.9195
www.CountryCasualTeak.com



A.B.E. NETWORKS

Technology Simplified

(301) 495-0964 | abenetworks.com

A.B.E. NETWORKS is the Washington area's premier custom residential and commercial technology design and integration firm. Our award winning organization utilizes premier products fused with your home's decor resulting in a top tier personalized experience.

 **LUTRON**[®]
LIGHTING CONTROLS
Authorized Platinum Dealer

Custom Automation Solutions | Audio/Video Systems | Network + Data Services | Integrated Security
Lighting Control Systems | Motorized Window Shades | Energy Monitoring | Infrastructure Management

STARK®

CARPET

FABRIC

FURNITURE

WALLCOVERING

BRING YOUR ROOM TO LIFE

INTRODUCING THE SAPPHIRE COLLECTION
TO THE TRADE WWW.STARKCARPET.COM

1099 14th Street NW, Suite 430 Washington, DC 20005 202.484.4566

RUG: NOT 118016A Halogen Collection #STARKTOUCH

Shot on Location: Olde Towne Southampton by Kean Development - Room Design by Ingrao Inc.



*Creating spaces you will love...
traditional, modern or somewhere in between.™*

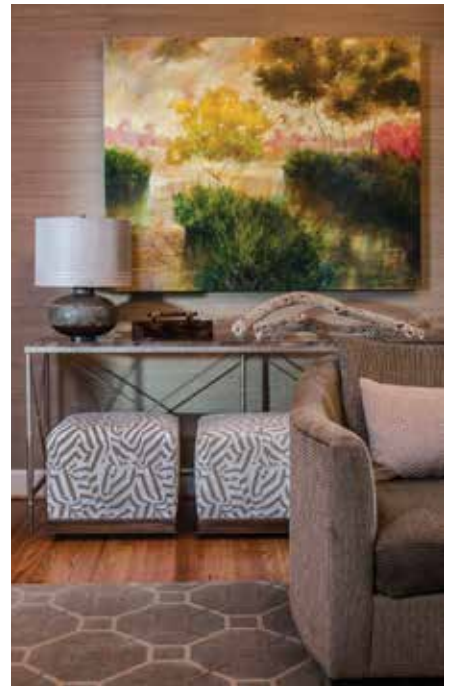

Visit ahouckdesigns.com and discover a style that speaks to you. Be inspired today.

Andrea Houck, Associate ASID, IFDA | Specializing in Residential Interior Design

ahouckdesigns.com | Arlington, Virginia | 703.237.2111





Tinge
LIFESTYLE BOUTIQUE



Beltway
7405 River Road Bethesda, MD
301.469.7690

Bethesda-Chevy Chase
5258 River Road Bethesda, MD
301.656.3311

Landscape Design|Build Center
7405 River Road Bethesda, MD
301.762.6301

americanplant.net

Congratulations Closets By Design.

Recognized as HOME & DESIGN 2016 Designers Choice Award
Favorite Custom Closet Company



Bob Narod, Photography, LLC

Custom Closets, Garage Cabinets, Home Offices and more...



**20% Off Plus
Free Installation**

20% off any order of \$1000 or more. \$100 off any order of \$700 or more. Not valid with any other offer. Free installation with any complete unit order of \$500 or more. With incoming order at time of purchase only.

Call for a free in home design consultation and estimate

703-330-8382

301-880-0866

www.closetsbydesign.com

Licensed and Insured

2009 © All Rights Reserved. Closets by Design, Inc.

HDM



**Closets
byDesign**

TABLE OF CONTENTS



31 18
32 14

LETTER FROM THE FOUNDERS..... 10

COMMITTEES, ADVISORS, LIAISONS, OFFICERS..... 12

ABOUT CHILDREN'S NATIONAL HEALTH SYSTEM 14

SPONSORS OF THE DC DESIGN HOUSE..... 16

CHILDREN'S HEALTH BOARD 18

CREATIVE & THERAPEUTIC ARTS SERVICES..... 20

SPONSORS & PARTNERS..... 24

BOUTIQUES 27

PRESENTING THE 2016 DC DESIGN HOUSE..... 31

FLOOR PLAN 32-34

INDEX OF SOURCES..... 57, 58, 60, 62

Paint Selections provided by Farrow & Ball

Disclaimer: The colors printed on Designer Pages are for illustrative purposes only and intended to be used only as approximations of authentic Farrow & Ball colors.

Program Book published by
Homestyles Media Inc.

Custom Publishing/Design Events/Publisher of

WASHINGTON, DC - MD - VA
HOME&DESIGN
The Magazine of Architecture and Fine Interiors

240-328-6275 | homeanddesign.com

Page 36/Area 1
FRONT GARDEN & PORCH
D. Blake Dunlevy & Gina Palmer
D & A Dunlevy Landscapers, Inc.

Page 37/Area 2
ENTRY HALL, HALL, BACK STAIR HALL
Eve Fay
Farrow & Ball

Page 38/Area 3
DINING ROOM
Jonathan Senner
Atelier Jonathan Senner

Page 39/Area 4
CHINA PANTRY
Nadia N. Subaran & Megan M. Padilla
Aidan Design

Page 40/Area 5
POWDER ROOM
Lena Kroupnik
Lena Kroupnik Interiors

Page 41/Area 6
A COZY, CORAL FAMILY ROOM
Kelley Proxmire
Kelley Interior Design

Page 42/Area 7
TERRACE
Kimberly Asner
Country Casual Teak

Page 43/Area 8
THE LIBRARY AND WHISKEY BAR
Josh Hildreth & Victor Sanz
DMG Interiors
Josh Hildreth Interiors

Page 44/Area 9
LIVING ROOM
Pamela Harvey
Pamela Harvey Interiors

Page 45/Area 10
MASTER BEDROOM SUITE
Victoria Sanchez
Victoria At Home

Page 46/Area 11
BEDROOM #2
Charles C. Almonte
Charles C. Almonte Architecture/Interior Design

Page 47/Area 12
LOFT
Melanie Hansen, Steve Corbeille & Pooja Bhagia Mittra
Yardstick Interiors

Page 48/Area 13
VINTAGE CABANA/ ROOF DECK
Quintece Hill-Mattauszek
Studio Q Designs

Page 49/Area 14
CHIC RETREAT
Barbara Brown
Barbara Brown Interiors

Page 50/Area 15
CHIC RETREAT - DRESSING ROOM & BATH
Barbara Brown
Barbara Brown Interiors

Page 51/Area 16
MADMOISELLE CHAMBRE
Andrea Houck
A. Houck Designs

Page 52/Area 17
THE CHIC LAUNDRY ROOM
Allie Mann
Case Design/Remodeling, Inc.

Page 53/Area 18
LADY LAIR
Rachel Dougan
ViVi Interiors

Page 54/Area 19
KITCHEN/BREAKFAST ROOM
Betsy Barbat Stiros
Frog Hill Designs

Page 55/Area 20
SITTING ROOM
Camille Saum
Camille Saum Interior Design

Page 56/Area 21
FORMAL IN THE WOODS
LOWER GARDEN
Stephen Wlodarczyk & Joshua Dean
Wheat's Lawn & Custom Landscape

One vision, one design and one builder to intergrate the pool and landscape into one magnificent creation.



Enrich your Home & Lifestyle



Town & Country Pools, Inc.

VA/DC (703) 451-6660 MD (301) 251-6661

www.townandcountrypools.com

info@townandcountrypools.com

MERRITT GALLERY

RENAISSANCE FINE ARTS



The Source for Fine Art & Custom Framing

Merritt Gallery · Chevy Chase Center · 5445 Wisconsin Avenue · Chevy Chase, MD · 301.564.4447

Merritt Gallery · Haverford Square · 385 W Lancaster Avenue · Haverford, PA · 610.645.9945

Renaissance Fine Arts · The Village of Cross Keys · 88 Village Square · Baltimore, MD · 410.484.8900

merrittgallery.com | renaissancefinearts.com

Shown: Sultan, *Reversal Poppies* series, Color Screenprint and Flocking, 46 x 46 in. each



NEWPORT BRASS.

Amisa Collection

YOUR HOME SAYS A LOT ABOUT YOU.
WE'RE HERE TO LISTEN.

Your home is a reflection of you. Ferguson's product experts are here to listen to every detail of your vision, and we'll work alongside you and your designer, builder or remodeler to bring it to life. Our product experts will help you find the perfect products from the finest bath, kitchen and lighting brands in the world. Request an appointment with your own personal Ferguson product expert and let us discover the possibilities for your next project.

Visit FergusonShowrooms.com to get started.

FERGUSON[®]
Bath, Kitchen & Lighting Gallery

ALEXANDRIA
(703) 658-1000

CHANTILLY
(703) 375-5858

ANNAPOLIS
(410) 573-6612

ROCKVILLE
(301) 424-1393

LETTER FROM THE FOUNDERS

Welcome to the 9th annual DC Design House – Washington, DC’s foremost residential design attraction and a leading annual fundraising event to benefit Children’s National Health System – and the first year in the fall. We are delighted to host the 2016 DC Design House at 2509 Foxhall Road NW in the recent temporary residence of the French Ambassador.

The DC Design House began in 2008 as a single event in which top area interior designers showcased their talents into a “flowing-themed design home” to raise money for Children’s National. The event was so successful that Skip and Debbie Singleton, Principals and Managing Partners of DC Living Real Estate, LLC, along with Sandy Steele and Taylor Wells formed a 501(c)3 non-profit entity to continue the event annually.

In the first eight years, over 70,000 visitors have come to the event helping raise over \$1,500,000 for Children’s National in support of the children and their families in our communities.

We would like to thank the dedicated Board of the DC Design House, Inc. and members of the Executive Committee for their tireless professional efforts, the many Volunteers who have generously donated their time, and the skillful Designers who have displayed their talents – all for the worthy cause of transforming children’s healthcare in our nation’s capital. We hope that you enjoy!

Sincerely,



P.L. Skip Singleton, Jr.
 Founder DC Design House
 Principal Broker/Managing Partner
 DC Living Real Estate, LLC

Debbie Singleton
 Founder DC Design House
 Principal/Managing Partner
 DC Living Real Estate, LLC

Founders of the DC Design House

Hopkins & Porter – Transforming the way people live since 1977



After



Before



Master bath, after

IF YOU CAN DREAM IT, WE CAN CREATE IT.

When service matters to you, call us.

Call for a Complimentary One Hour Consultation.



COMMITTEES, ADVISORS, LIAISONS & OFFICERS

DC DESIGN HOUSE FOUNDERS

Skip and Debbie Singleton

CORPORATE OFFICERS

P.L. Skip Singleton, Jr. Esq.
- President

Taylor Wells
- Treasurer

DC DESIGN HOUSE BOARD

Kathy Barker

Susan Hayes Long

Sherry Moeller

Randie Reilly

P.L. Skip Singleton, Jr. Esq.

Debbie Singleton

Taylor Wells

DESIGN ADVISORS

Barry Dixon

Michael Hampton

Sally Steponkus Roche

EXECUTIVE COMMITTEE

Kathy Barker

Karen Bailey

Iantha Carley

Christina Emmerman

Cristy Heffernan

Susan Hayes Long

Sherry Moeller

Sharon Putterman

Randie Reilly

Stephanie Robinson

Jean Seline

Taylor Wells

Susan Wisor

DESIGNER LIAISON

Taylor Wells

At Home Group

PRESS LIAISON

Sherry Moeller

MoKi Media

*In remembrance of Founding Board Member
and Corporate Officer Sandra Steele*



25

cheers to 25 fabulous years!

Thanks to our wonderful customers for 25 great years!

Come celebrate with us & explore our exciting fall lineup
during our spectacular 25th Anniversary Sale!

U·R·B·A·N
COUNTRY®

homefurnishings for countryside and urban spaces

7117 Arlington Rd., Bethesda, MD • 301-654-0500 • urbancountrydesigns.com



DISCOVER FARROW & BALL AT:

Farrow & Ball Washington, DC, 202 479 6780 | Patrick Street Interiors, Frederick, MD, 240 575 5875
Windo VanGo, Marriottsville, MD, 410 521 1700 | Color Wheel, McLean, VA, 703 356 8477
Interiors by Moyanne, Lynchurg, VA, 434 941 2672 | Palette Paint and Home, Charlottesville, VA, 434 328 2906
Palette Paint and Home, Richmond, VA, 804 716 1742 | Potomac Paint and Design, Alexandria, VA, 703 379 5800
The Paint Shop, Warrenton, VA, 540 347 4484

WWW.FARROW-BALL.COM



CHILDREN'S NATIONAL HEALTH SYSTEM

ABOUT CHILDREN'S NATIONAL HEALTH SYSTEM

Children's National Health System, based in Washington, DC, has been serving the nation's children since 1870. Children's National is Magnet® designated and was ranked among the top 10 pediatric hospitals by U.S. News & World Report 2015-16. Home to the Children's Research Institute and the Sheikh Zayed Institute for Pediatric Surgical Innovation, Children's National is one of the nation's top NIH-funded pediatric institutions.

With a community-based pediatric network, seven regional outpatient centers, an ambulatory surgery center, two emergency rooms, an acute care hospital, and collaborations throughout the region, Children's National is recognized for its expertise and innovation in pediatric care and as an advocate for all children.

With support provided through philanthropy, the experts of Children's National develop therapies, find cures, and improve children's health in our community, across the nation, and around the world.



For more information, visit
childrensnational.org

Don't miss out on the **LOWEST** rates in history.

Build or buy your new home with our Portfolio – Dr loans – Private wealth – Fixed construction to permanent loans – renovation loans – all in house lending.



When you are looking to Build, Remodel or Purchase your Dream Home, look no further than Susan Turner at Citizens Bank!

Susan specializes in:

- > Portfolio Lending – unique high-end Products, Clients and Builders
- > “True One-Time Close” Construction-Perm financing with the rates locked at time of application
- > 30 Year Financing, with 10 Year Interest Only Options
- > Medical Professional Financing, with low down payments and No Mortgage Insurance
- > Special High Loan-to-Value Financing with No Mortgage Insurance (10% Down Construction Perm to \$850,000, 15% Down Purchase to \$1,000,000)
- > Special Asset Dissipation Programs

Susan Turner is ranked nationally as a Top Producer in Scotsman Guide. Let Susan and her team help you get your dream home today!



Susan Turner

Assistant Vice President & Personal Mortgage Banker

NMLS ID#783571

Cell (301) 651-2174

susan.turner@citizensone.com



SPONSORS OF THE DC DESIGN HOUSE

Gold

| | |
|-------------------------|------------------------|
| At Home Group | Farrow & Ball |
| Children's Health Board | HOME & DESIGN Magazine |
| DC Living Real Estate | MoKi Media |

Silver

| | |
|------------------------------|-----------------------|
| Angie Seckinger Photographer | FRED Home Improvement |
| Foxcraft Design Group | Thos. Moser |

VIP Sponsor

A.B.E. Networks
Kathy & Norm Barker

Patron Sponsor

| | |
|------------------------|----------------------------|
| Bob Narod Photographer | Solution Painting, Inc. |
| Kathy & Alan Bagden | Werco Carpeting & Flooring |

Friend Sponsor

Georgetown Cupcake
Sub-Zero & Wolf Showroom by Fretz
The Donaldson Group

SUPPORTERS OF THE DC DESIGN HOUSE

| | |
|----------------------------|-----------------------|
| CriLu Educational Services | Rosalia Miller |
| Helaine Mario | Susan & Russell Wisor |
| Mary Hale Corkran | |



MASS AVE HEIGHTS, WASHINGTON, DC
Private gated Beaux Arts 1927 estate on over 1 acre of grounds and pool. Grand entertaining, 12" ceilings, 5/6BR + staff quarters, terraces overlook Rock Creek Park. \$12,000,000
Chuck Holzwarth 202-285-2616



FOXHALL, WASHINGTON, DC
A Gibson Builders Masterpiece! Craftsmanship of the highest quality throughout. Five levels including staff quarters. This one is a must see! \$11,800,000
Nancy Itteilag 202-905-7762



RITZ/WEST END, WASHINGTON, DC
Extraordinary 2-level penthouse with unbelievable sunset & NW views has been expanded and meticulously renovated by renowned designer Darryl Carter. \$7,695,000
Mark McFadden 703-216-1333



KALORAMA, WASHINGTON, DC
Sophisticated home with 7BR, 7BA, & 2HBA on 1/4 acre. Approx. 8,000 SF of living area. Grand entertaining spaces, elevator, gardens, pool, & 6-car parking. \$6,995,000
Cynthia Howar 202-297-6000



FOXHALL, WASHINGTON, DC
Georgian on 1.5 acres, renovated in 2008. Well-proportioned rooms, high ceilings & open floor plan. Pool, 3 car garage & parking for 12-20. 6-8BR, 6F/2HBA. \$6,500,000
Nancy Itteilag 202-905-7762



KALORAMA, WASHINGTON, DC
Contemporary renovation of Waddy Wood 6BR, 6.5BA mansion. Open bright floor plan, high ceilings, stunning fixtures, outdoor terraces. Over 7,000 square feet. \$5,600,000
Cynthia Howar 202-297-6000



GEORGETOWN, WASHINGTON, DC
Beautiful 4550 SF penthouse on 2 levels with elevator & wine cellar. Soaring ceilings. Fabulous kitchen. 4BR, 3.5BA, 3-car pkg. \$4,795,000
Mary Grover Ehrgood 202-274-4694
Julia Ehrgood Ghafouri 202-274-4682



SPRING VALLEY, WASHINGTON, DC
Elegant, private 6 bedroom, 5.5 bath offering gourmet kitchen, conservatory, master suite with his/hers baths, lower level with theater and 2-car garage. \$3,895,000
Cynthia Howar 202-297-6000



KENT, WASHINGTON, DC
Exquisite finishes, fabulous family room/kitchen combo, 2 master suites + 2 BRs up. Finished LL, large, level yard (.45 acre). Garage. \$3,750,000
Heidi Hatfield 202-243-1634
Anne Hatfield Weir 202-243-1635



SOMERSET, CHEVY CHASE, MARYLAND
Renovated with 3,000+ SF millwork, hardwoods, moldings. Living + dining rooms, library/den, gourmet eat-in kitchen, double balconies. Doorman, health club, pool! \$3,298,000
Nancy Itteilag 202-905-7762



WESLEY HEIGHTS, WASHINGTON, DC
4700 SF, 6BR/4.5BA. Renovated 2005. Fam room with fireplaces open to kitchen & breakfast room, garden/pool, 2 pool houses. \$2,695,000
Chuck Holzwarth 202-285-2616
Stephanie Bredahl 202-821-5145



SPRING VALLEY, WASHINGTON, DC
Renovated 4 level 5BR/4.5BA, eat-in kitchen opens to great room with fireplace & 18' ceilings opens to rear garden. Att garage. \$2,595,000
Chuck Holzwarth 202-285-2616
Stephanie Bredahl 202-821-5145



ALEXANDRIA, VIRGINIA
Rarely available stately colonial with nearly 8,000SF. Custom designer built-ins. 2-story foyer. Elevator. 4BR+nanny room, 4.5BA & 4 car garage, circular driveway. \$2,495,000
Linda Rogers 703-627-6776



BERKLEY, WASHINGTON, DC
Foxhall Crescents - Enjoy coffee in the kitchen or the back patio. Three levels perfect for entertaining and everyday living with one of the largest gardens. Elevator! \$2,000,098
Nancy Itteilag 202-905-7762



COUNTRY CLUB HILLS, ARLINGTON, VA
Expanded & Renovated - 4BR, 4BA, 2 car garage & large, sun filled family room addition with vaulted ceiling. Flat 1/2 acre lot \$1,999,000
Stacey Romm 703-298-8197
Peggy Richardson 703-346-8326



FOREST HILLS, WASHINGTON, DC
Beautifully updated four bedroom Colonial with contemporary flare! Lush views from every room. Garage and guest parking. \$1,375,000
Nancy Itteilag 202-905-7762

ABOUT CHILDREN'S HEALTH BOARD



Founded in 1866 to feed starving orphans after the Civil War, the Children's Health Board (CHB) is a non-profit organization and exclusive service and philanthropic affiliate of Children's National Health System. Since 2000, the CHB has provided over \$5 million in funding for priority Children's National initiatives to advance the health and well-being of children in our community, especially those most in need, through advocacy, education, prevention, and early intervention.

In 2006, CHB pledged \$1,000,000 as the founding sponsor of the Child Health Advocacy Institute (CHAI) and its Child Health Data Lab to proactively address health threats impacting children and to serve as an influential national voice in the development of child health policy.

Through its annual grants program, CHB also supports numerous health and well-being oriented initiatives including asthma management, immunizations, injury prevention, oral health, infant heart defect screening, early intervention mental health, and family programs through Children's National community health centers in Shaw, Adams Morgan, and Anacostia.

In 2009, CHB made a \$500,000 commitment to become a founding sponsor of the Obesity Institute at Children's National. It has become a national model and leads the

effort to create innovative solutions to help children achieve healthy weights and protect them from risks associated with being overweight—through treatment, advocacy and public policy, research, and education.

In 2015, CHB made a \$500,000 commitment to the Dental Clinic Renovation at Children's National. This will enable the Clinic to serve 12,500 dental patients per year, 2,500 more than are being served now. With a new "state-of-the-art" Dental Clinic, Children's National will attract the best and brightest dental residents from the best dental schools in the country and beyond. At the same time, the hospital is "computerizing" all dental records. Good oral health is fundamental to good health in general.

Our goal is to help children in our community, and beyond, stay healthy and thrive where they live, learn, and play.

For more information on the Children's Health Board, please contact: Rosalia Miller, President of the Children's Health Board

**e-mail: rosalia.miller@gmail.com
childrenshealthboard.org**

CREATE YOUR PERFECT SPACE

With more than 50 years of transforming homes in the DC metro area, Case offers the highest quality in design and craftsmanship, unbeatable client service and the best warranty in the business.

Visit casedesign.com or call 800.513.2250 to schedule a free consultation.



BECAUSE IT'S YOUR HOME

DC | MD | VA



Gretchen Everett

Drapery | Furniture | Hardware

PROUD PARTICIPANT
IN THE
2016 DC DESIGN HOUSE

WITH THE TALENTED DESIGN TEAMS
OF

Kelley Interior Design
Camille Saum Interior Design
VIVI Interiors
Atelier Jonathan Senner
Aidan Design

gretcheneverett.com | To the Trade | 301.495.2978

CREATIVE & THERAPEUTIC ARTS SERVICES

Studio Artistica and Children's National present the Healing Garden, Happiness Is... and Garden with Wings

The Creative & Therapeutic Arts Services at Children's National Health System, led by Gallery & Exhibition Coordinator Gregory Scott, collaborated with Lisa Tureson and Tracie Weir of Studio Artistica to create artwork painted by patients and high school volunteers to be sold at this year's DC Design House.

Combining the healing power of art therapy, therapeutic music, animal visitations and performing arts to inpatients, outpatients and their families, the Gallery Coordinator brainstormed with Studio Artistica to develop themes for the art projects with a focus on healing. The Healing Garden, Happiness Is..., and Garden with Wings will be comprised of about 60 canvases, painted in various sessions by patients and volunteers, as well as Gregory Scott, Lisa Tureson and Tracie Weir.

The high school volunteers, who are part of an eight-week summer program, painted the Healing Garden, while Happiness Is... and Garden with Wings were painted by patients. Even hospital staff

and parents joined in. Garden with Wings, consisting of 13 butterfly paintings, represents endurance, hope, change and life.

"As an artist, I want to raise awareness about the value of art therapy," says Lisa Tureson. "As a human, I just wanted to see these kids have some enjoyment."

"The flower that blooms in adversity is the rarest and most beautiful."

"You really made my day," was 7-year-old Donovan's cheerful reaction to the news that his painting was going to be available for sale as a print! Donovan is an inpatient who thoroughly enjoyed himself while painting.

In addition, Lisa Tureson and Tracie Weir of Studio Artistica will display and sell original art from their Scribbles series, which is inspired by a recent trip to Denmark. www.studioartistica.com



Helping Hands painting in the Healing Garden



Art by Donovan, a patient at Children's National



High school volunteers work with Studio Artistica and Creative & Therapeutic Arts Services to create art for the Healing Garden



Garden with Wings by patients, parents and hospital staff consists of 13 butterfly paintings



One mural in the Healing Garden painted by patients, high school volunteers, Studio Artistica and Creative & Therapeutic Arts Services staff

KELLEY
Interior
DESIGN

Kelley Proxmire
 2016 Home & Design
 Designers' Choice Award
 Hall of Fame Designer

4519 Wetherill Road
 Bethesda, MD 20816
 301.320.2109
www.kelleyinteriordesign.com

IF IT DOESN'T UPSET
 YOUR ALLERGIES
 LIKE PAINT...

IS IT STILL PAINT?

Benjamin Moore
 Paint like no other.

Visit your local
 Benjamin Moore store today.

NATURA
 Certified asthma & allergy friendly™
 Only at Benjamin Moore retailers.





GILDAY

RENOVATIONS



Architecture | Interior Design | Construction

301-565-4600 GILDAY.COM

Designing a Finer Life.



TOBE DesignGroup

4948 Saint Elmo Ave., Suite 210, Bethesda, MD 20814
301.656.6600 | www.tobedesigngroup.com

ALL YOU NEED IS LIGHT

The Oriona 3 light pendant in antique gold leaf brings a unique look to any home. Visit one of our lighting showrooms to see all the new arrivals.

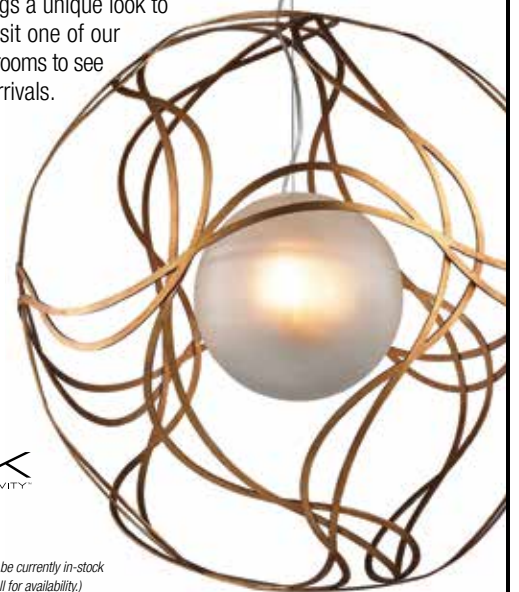

ELK
LIGHTING CREATIVITY

(*Items shown may not be currently in-stock or on display. Please call for availability.)

DOMINION
ELECTRIC SUPPLY COMPANY, INC.

www.DominionElectric.com



Lighting Showrooms

Arlington 703-536-4400

Chantilly 703-631-8300

Laurel 301-470-2121



Care Kids

The Shopping Fundraiser with Heart
Presented by The Board of Visitors

Benefiting



**Children's
National™**

Give \$50 and Enjoy a 20% Shopping Discount
at Hundreds of Stores and Restaurants
Friday, October 21 - Sunday, October 30, 2016

Download the "**Care for Kids Shopping Pass**"
App from the App Store or Google Play.

To learn more visit:
BoardofVisitors.com/CareforKids

Official Program Partner

LONG & FOSTER

REAL ESTATE

LUXURY HOMES

CHRISTIE'S
INTERNATIONAL REAL ESTATE

SPONSORS & PARTNERS



Angie Seckinger Photography



FRED DOES:



Our consultants and craftsmen bring years of experience, industry certifications and a genuine passion for what they do to every project, large and small. You can trust FRED with your home. FRED DONE.

Visit www.ScheduleFRED.com today to speak with a consultant.

firedSM
the first name in home improvement

www.ScheduleFRED.com

MD: 301.560.3733 VA: 703.536.3733 DC: 202.582.3733

A DIVISION OF CASE

DC Living[®]
REAL ESTATE, LLC
DCLiving.com

A Smart Firm



Your Best Move
DC*VA*MD
15 YEARS



SALVATIONS
ARCHITECTURAL FURNISHINGS

From Raw Iron
to Refined Elegance

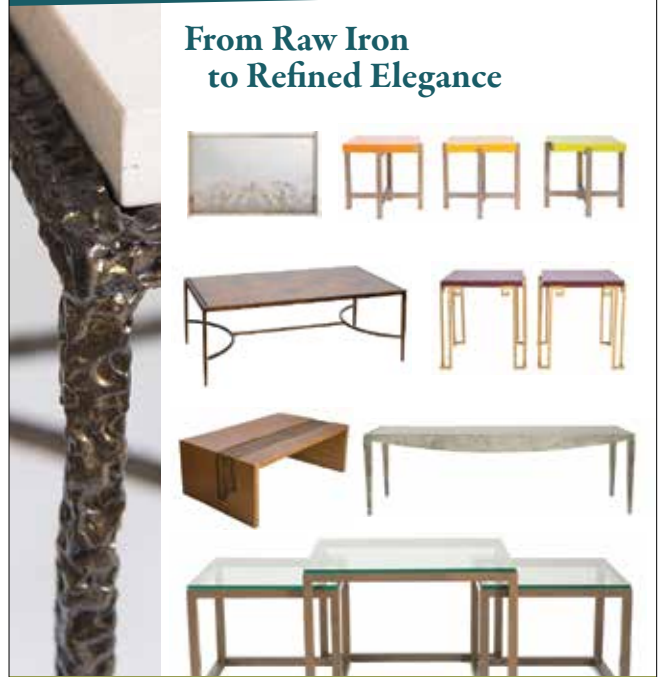

Original artisan ironwork since 1986

www.salvationsaf.com



Paint Like No Other®

Brilliant, Rich, Everlasting Color

Our most premium paint, engineered to deliver unrivaled color quality and exceptional coverage in fewer coats.



**Visit your local Benjamin Moore store today.
To find your nearest store go to benjaminmoore.com.**

©2016 Benjamin Moore & Co. Aura, Benjamin Moore, Color Lock, Green Promise, Paint like no other, and the triangle "M" symbol are registered trademarks licensed to Benjamin Moore & Co.

appliances
hardwood
lighting
plumbing
stone + tile

mosaic tile
home interiors
www.mosaictileco.com

Alexandria: 821 S. Pickett St. 703.310.6852
Chantilly: 3935 Stonecroft Blvd. 703.631.4848



Norwood Stone Corporation has been providing the highest quality stone fabrication and installation to designers, architects, builders and general contractors for over 30 years.

Phone: (301) 887-1014
Fax: (301) 887-1018

norwoodstone.com

BOUTIQUES

Boutiques will be open for business to serve ticket holders all days/ times the Design House is open to the public. A percentage of all boutique sales will benefit the Children's National Health System, a cutting edge leader in children's healthcare, providing world-class care to all patients regardless of their ability to pay.

JEFF L DESIGNS

BY JEFF LIABRAATEN

This will be Jeff's 7th year at the DCDH. Please stop by and check out fabulous new, vintage and antique furniture and home accessories.

3807 Chanel Road
Annandale, VA 22003
571-225-8100
jeff@jefflidesigns.com



WHYTE HOUSE MONOGRAMS

BY DEBBIE MCCARTHY WHYTE

Whyte House Monograms brings its elegant monogramming to a wide variety of gifts and home design accessories. This year we will be featuring personalized linens for the bed and bath as well as wonderful home accents to enhance any room in your home. We will also have fabulous gifts for men, women and children. There is something for everyone at Whyte House Monograms.

Whyte House Monograms Chevy Chase
5801 Hillburne Way
Chevy Chase, MD 20815
301-657-5073
whytehousemonograms@gmail.com
whytehousemonograms.com



IBHANA BOUTIQUE

BY MEENA THARMARATNAM

Ibhana offers women's apparel and accessories by American, Canadian and European designers. Washable, wrinkle free, fashion forward designs for work, travel and play. Sizes 2 through 20. Scarves and shawls in silk and cashmere. A unique experience!

Potomac Woods Plaza
1079 Seven Locks Road
Rockville, MD 20854
301-424-0906
IBHANA1@gmail.com
ibhanaboutique.com



COCO BLANCA

BY SUSAN NEITHAMER, GAYLA REED AND ELISABETH SQUIRE

Featuring fashion, jewelry, furniture, lighting, tabletop, home accessories, and gifts. We now have two locations:

| | |
|---|---|
| Wildwood Shopping Center 10241 Old Georgetown Road Bethesda, MD 20814 301-493-9000 cocoblanca.com | Old Town Alexandria 210 South Union Street Alexandria, VA 22314 703-535-8002 cocoblanca.com |
|---|---|





2015 winner of the Good Design Award,
as awarded by The Chicago Athenaeum
Museum of Architecture and Design

INTERIOR
DESIGN
**BEST
OF
YEAR 2014**

Thos. Moser

HANDMADE AMERICAN FURNITURE

CUMBERLAND DINING

1028 33rd Street NW · Washington, DC · thosmoser.com



PEYTONHOME

& The Maryland Design Center

SHOWROOM & ORDERING SOURCE TO THE TRADE

MARYLAND'S ONLY "TO THE TRADE" INTERIOR
DESIGN SHOWROOM

&

A COMPLETE ORDERING SOURCE

Featuring:

Century Furniture, Vanguard, Cisco, Old Biscayne, Lorts,
Thayer Coggin, Chaddock, Theodore Alexander, Kravet, Robert
Allen, Osborne & Little, Duralee, Lillian August, Hickory White
and many more.

THE MARYLAND DESIGN CENTER (MDC) IS CONVENIENTLY
LOCATED IN THE BALTIMORE METROPOLITAN AREA.
OUR SHOWROOM PROVIDES THE DESIGN TRADE WITH
ACCESS TO OUR INDUSTRY'S PREMIER TEXTILE HOUSES,
FURNITURE, LIGHTING & HOME FURNISHING LINES.

11409 Cronhill Dr Suite G, Owings Mills, MD 21117
410-998-9424 | www.peytonhome.com

FRED DOES:

PAINTING
PLUMBING
TILES
FLOORING
VANITIES
WINDOWS
DOORS
AND MORE...

fred

the first name in
home improvement

MD: 301.560.3733 VA: 703.536.3733 DC: 202.582.3733

www.ScheduleFRED.com

A DIVISION OF **CASE**

Resale Furniture LUXURY



EISENHOWERCONSIGNMENT.COM

4926 EISENHOWER AVENUE, ALEXANDRIA, VA 22304

703.751.1624

**An Award Winning
Full Service Design Build Firm**
Quality Craftsmanship & Exceptional Service



Photo by Greg Hadley Photography

**FOXCRAFT
DESIGN
GROUP, INC**

▲ Design ▲ Build ▲

Whole House Remodels ▲ Large Additions
Extensions ▲ Kitchens ▲ Bathrooms

110 Great Falls Street ▲ Falls Church, VA 22046
703.536.1888

www.FOXCRAFT.com

Since 1989 ▲ 27 Years of Excellence

Angie Seckinger



INTERIORS & FINE ART PHOTOGRAPHY

ANGIESECKINGER.COM
MACROJOURNEY.COM

Fine European Linens • Custom Embroidery • Monogramming • Custom Sizing

ABRIELLE

FINE LINENS & LINGERIE



Linens by... DEA • Matouk • Deborah Rhodes • Sferra

3301 New Mexico Ave. NW Washington DC 20016
(202) 364-6118 abriellelinens@gmail.com [f/AbrielleFineLinens](https://www.facebook.com/AbrielleFineLinens)

An Award Winning
Full Service Design Build Firm
Quality Craftsmanship & Exceptional Service



by Greg Hadley Photography

FOXCRAFT
DESIGN
GROUP, INC

▲ Design ▲ Build ▲

Whole House Remodels ▲ Large Additions
Extensions ▲ Kitchens ▲ Bathrooms

110 Great Falls Street ▲ Falls Church, VA 22046
703.536.1888

www.FOXCRAFT.com

Since 1989 ▲ 27 Years of Excellence

LIFE IS TOO SHORT TO LAY ON UGLY PILLOWS



www.nakeddecor.com

PRESENTING THE 2016 DC DESIGN HOUSE



GTM Architects/Gibson Builders

Photo by Angie Seckinger

Former French Ambassador's Residence is the Site of the 2016 DC Design House

Designed by GTM Architects and built by Gibson Builders, the 11,242-square-foot home at 2509 Foxhall Road, NW, Washington, DC, 20007 is the site of the 9th Annual DC Design House. Located in the Wesley Heights/Berkley neighborhood, the estate was most recently used as the temporary residence for the French Ambassador while his permanent home was undergoing renovations. It is also located next door to the 2013 DC Design House.

Offering five stories on a three-quarter-acre lot, the home includes seven bedrooms, eight full bathrooms, two half baths, three kitchens, and five fireplaces. A sauna, wine cellar, exercise and party rooms, steam showers, elegant moldings and arched doorways, an elevator, and an infinity pool are among the luxury amenities of this home, listed by Nancy Itteilag of Washington Fine Properties.

2509 Foxhall Road, NW, Washington, DC 20007

FLOOR PLAN

FIRST FLOOR

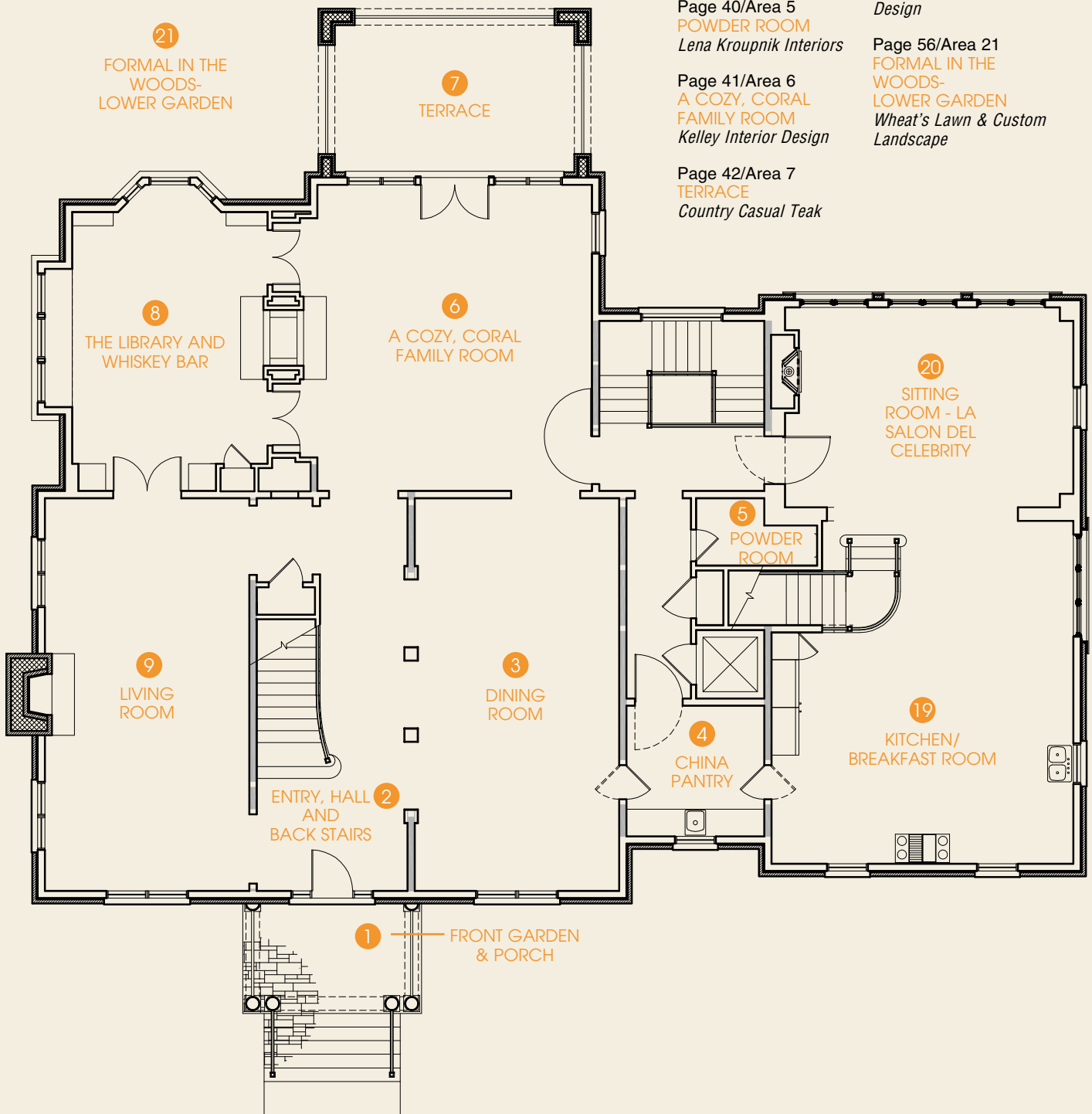

Page 36/Area 1
FRONT GARDEN & PORCH
D & A Dunlevy
Landscapers, Inc.

Page 43/Area 8
THE LIBRARY AND WHISKEY BAR
DMG Interiors
Josh Hildreth Interiors

Page 37/Area 2
ENTRY, HALL AND BACK STAIRS
Farrow & Ball

Page 44/Area 9
LIVING ROOM
Pamela Harvey Interiors

Page 38/Area 3
DINING ROOM
Atelier Jonathan Senner

Page 54/Area 19
KITCHEN/BREAKFAST ROOM
Frog Hill Designs

Page 39/Area 4
CHINA PANTRY
Aidan Design

Page 55/Area 20
SITTING ROOM - LA SALON DEL CELEBRITY
Camille Saum Interior Design

Page 40/Area 5
POWDER ROOM
Lena Kroupnik Interiors

Page 56/Area 21
FORMAL IN THE WOODS-LOWER GARDEN
Wheat's Lawn & Custom Landscape

Page 41/Area 6
A COZY, CORAL FAMILY ROOM
Kelley Interior Design

Page 42/Area 7
TERRACE
Country Casual Teak

SECOND FLOOR

Page 45/Area 10
MASTER BEDROOM
SUITE
Victoria At Home

Page 46/Area 11
BEDROOM #2
*Charles C. Almonte
Architecture/Interior
Design*

Page 51/Area 16
MADEMOISELLE
CHAMBRE
A. Houck Designs

Page 52/Area 17
THE CHIC LAUNDRY
ROOM
*Case Design/Remodeling,
Inc.*

Page 53/Area 18
LADY LAIR
ViVi Interiors

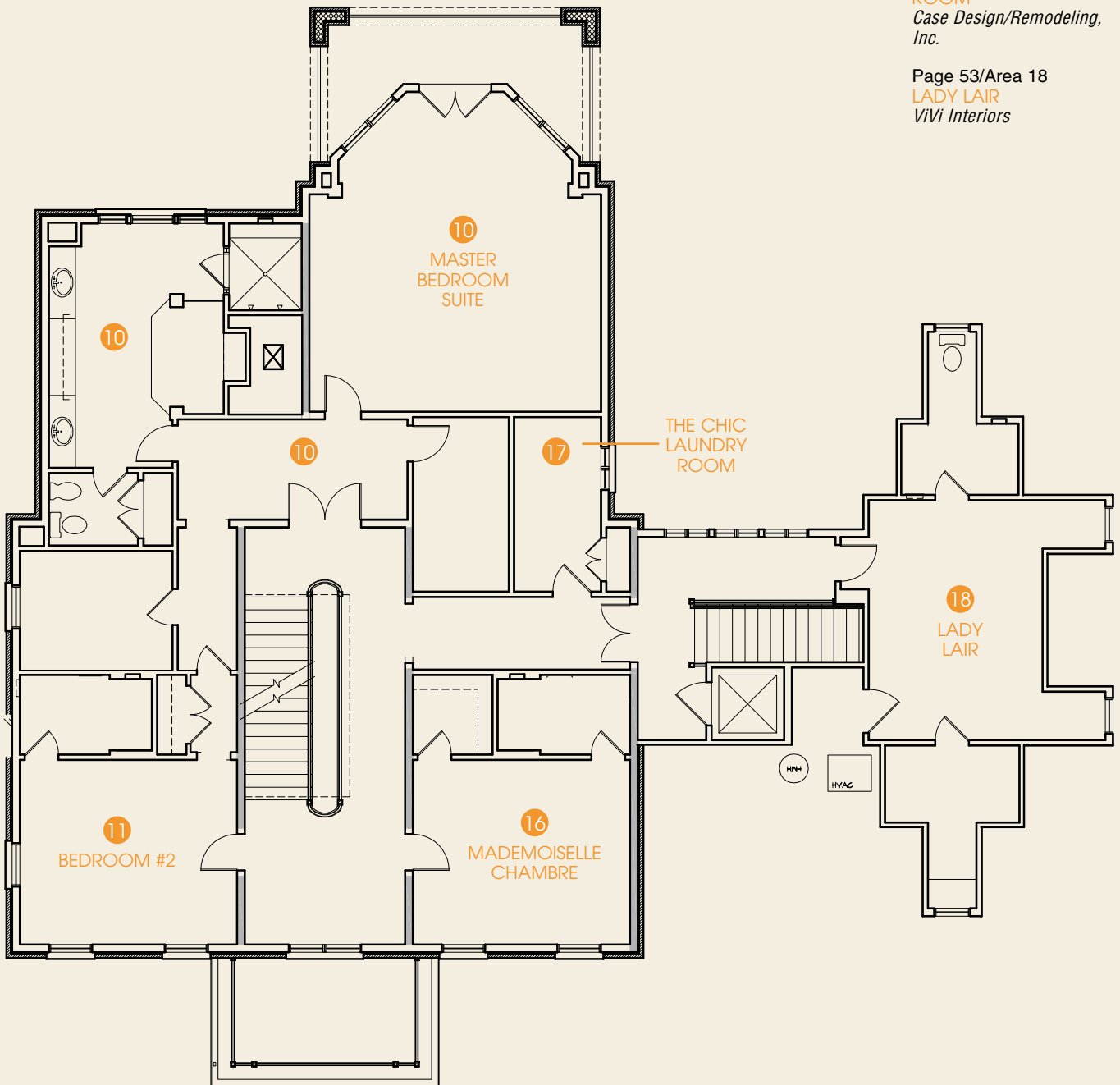

FLOOR PLAN

THIRD FLOOR

Page 47/Area 12

LOFT

Yardstick Interiors

Page 48/Area 13

VINTAGE CABANA/
ROOF DECK

Studio Q Designs

Page 49/Area 14

CHIC RETREAT

Barbara Brown Interiors

Page 50/Area 15

CHIC RETREAT -
DRESSING ROOM &
BATH

Barbara Brown Interiors

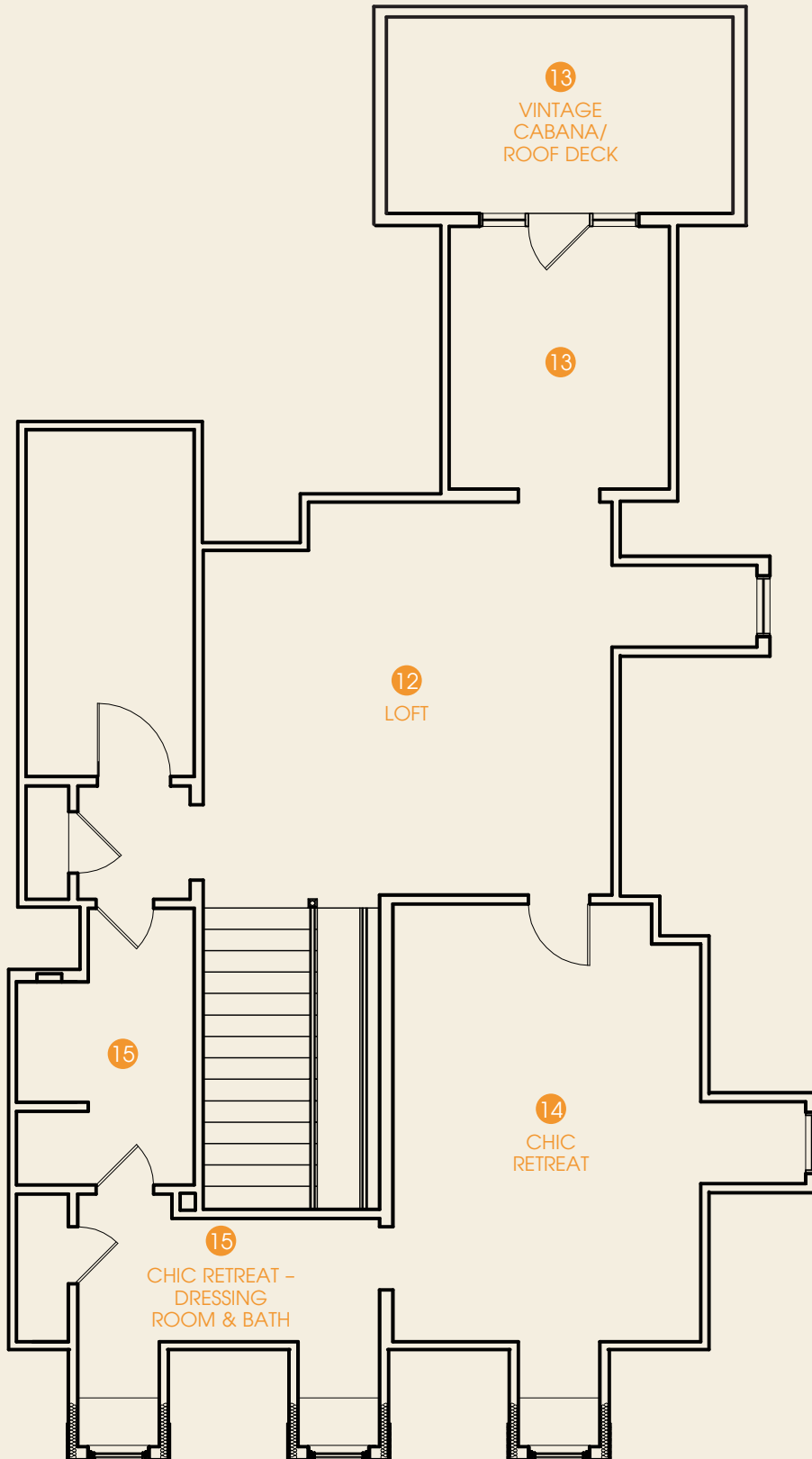



pie sisters
georgetown
Tradition starts here

Cater your next event with us!
Pie Sisters Georgetown
3423 M St NW
Washington DC 20007
Piesisters.com

MoKi Media is honored to be a sponsor of the DC Design House for the 6th Year.

We offer comprehensive PR and marketing campaigns for design and luxury lifestyle professionals.



SHERRY MOELLER
301.807.0910 : SHERRY.MOELLER@MOKIMEDIA.COM





ARCHITECTS OF "THE DC DESIGN HOUSE"
www.gtmarchitects.com
7735 Old Georgetown Road, Suite 700, Bethesda, Maryland
240 333 2000

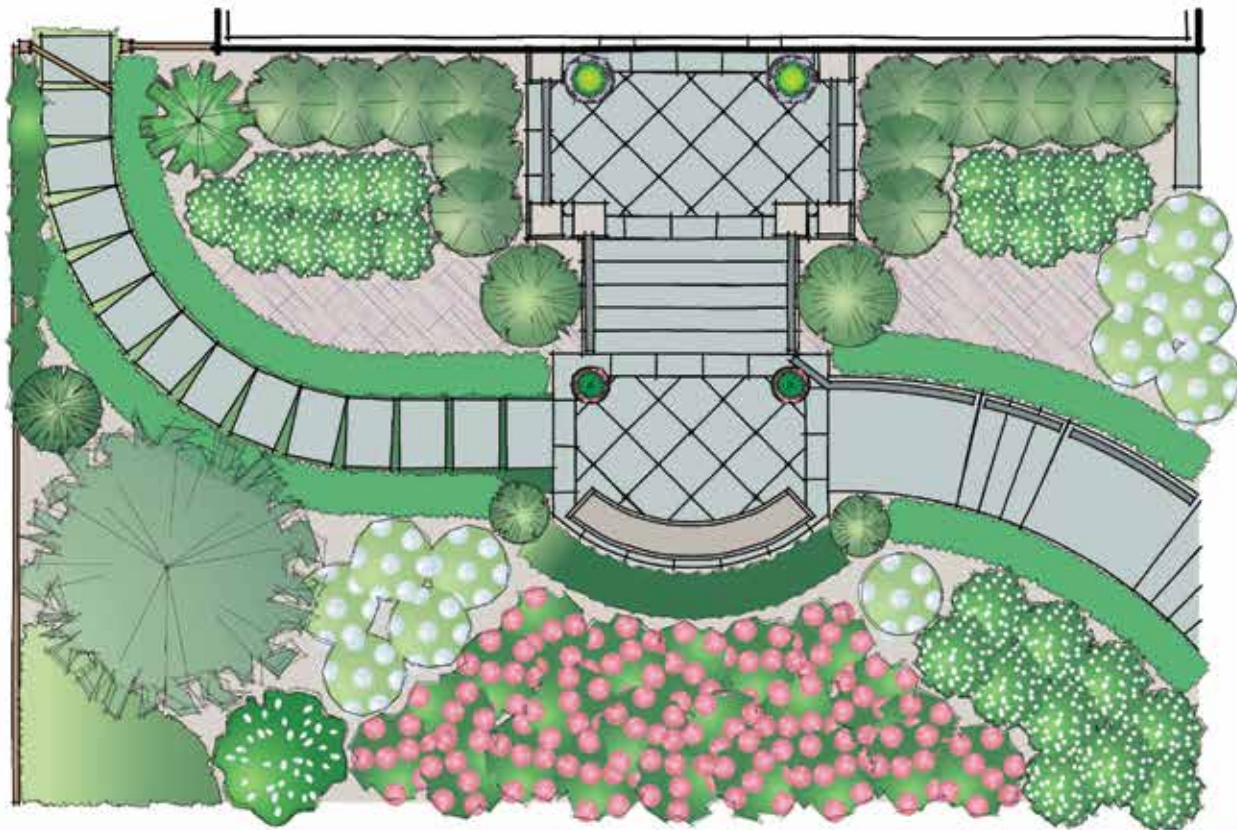

AREA 1 FRONT GARDEN & PORCH

The key to a beautiful home begins at the door to the home; more specifically, it starts in the area that leads up to the door of the home. The front garden of this lovely DC home sets the tone and begins the guest's experience by creating an orderly yet flowing space. The flagstone lead walk draws you onto a generous landing which is bordered by a custom-built bench and decorative planters. Ascending the steps to the cover of the portico, one notices the well-manicured, multi-layered planting displays that encase the entry to the right and left. Once the top landing is reached, you find a warm front door framed on either side by elegant planters that boast a rich display of greenery. If the front garden is any indication, this home is sure to provide a tasteful and timeless walk through a bouquet of finely designed spaces.

ABOUT THE DESIGNERS

D. BLAKE DUNLEVY & GINA PALMER

With 34 years of experience, D & A Dunlevy Landscapers, Inc. has designed, constructed, and maintained countless gardens and landscapes. Designers D. Blake Dunlevy and Gina Palmer share a well-versed background in landscape architecture studies. Their inspiring attention to detail is matched by their creativity, resulting

in consistent fine craftsmanship on each project. A diverse team of professionals in landscape and construction allows Blake and Gina to provide fully developed designs, all of which are implemented in-house. Their designs seek to draw people outdoors by combining the beauty of horticulture with appealing construction elements.



**D. BLAKE DUNLEVY
& GINA PALMER**
D & A DUNLEVY
LANDSCAPERS, INC.

PO Box 70
Barnesville, MD 20838
301-977-7593
dadhunlevy.com



AREA 2 ENTRY, HALL AND BACK STAIRS

No other space in the house presents quite as many challenges as the entry and hallway. The goal is to strengthen the relationship the hallway has with the rooms that adjoin it. The entry sets the stage and tone for the house by creating a sense of flow and unity. Enigma by Farrow & Ball is a beguiling and bold geometric wallpaper design. Encompassing a series of interlocking rectangles, the deceptively simple and dynamic paper is the perfect link to its surrounding rooms. Using this uniquely textured paper in two colour options, we were able to create a delicate neutral feeling in the entry and a bolder tone in the back staircase while enhancing the relationship between these connected spaces. Our approach has resulted in a greater sense of flow and drama.

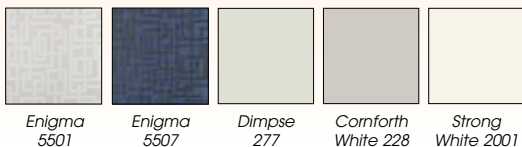

ABOUT THE DESIGNER

EVE FAY

Eve Fay is the Colour Consultant and Manager of the Farrow & Ball showroom in Washington, DC. Eve works with the Farrow & Ball colour palette every day and has a wealth of knowledge on the use and selection of colour for the home. Her projects embody collaborative efforts that balance the client's needs and taste with her own expertise in colour,

architecture, and design, creating truly unique and inspired spaces.

Eve's adventure in colour and design began in 1967 with a gift of a Colorform set from her parents. Today, she spends her free time visiting historic properties, flipping houses, and wondering what your favorite colour is. Eve's favorite is orange – the colour of optimism.



EVE FAY
FARROW & BALL

5221 Wisconsin Avenue, NW
Washington, DC 20015
washington.showroom@farrow-ball.com



AREA 3 DINING ROOM

How about dinner in Paris tonight? Look no further than the dining room. The core inspiration is Schumacher's "La Cité" wallcovering, a reproduction of the 1739 Turgot Map of Paris, which is complemented by a shimmering ceiling paper reminiscent of antiqued mirror. The room's centerpieces—two custom dining tables handcrafted of dark walnut and book-matched zircote by Keith Fritz Fine Furniture—stand atop creamy Stark carpets. Sumptuous fabrics from Beacon Hill/Robert Allen and curated furnishings abound. An antique Louis XVI-style settee in a black-and-white silk stripe, vintage armchairs in an emerald-green velvet, mid-century chrome-and-leather side chairs, and lush green silk drapes are mixed with an Art Deco-style faux-malachite credenza and a 1970's mushroom lamp. New pieces—including étagères by Baker, a marble-and-brass bar by Mitchell Gold + Bob Williams, recent bronze sculptures courtesy of Merritt Gallery, and illumination from Circa Lighting—lend a contemporary sensibility. Bon appétit!



Slipper Satin
2004



Pointing
2003

ABOUT THE DESIGNER JONATHAN SENNER, C.I.D.

A native of Montana with a lifelong passion for interiors and design, Jonathan Senner has called Washington, DC home for more than 12 years. "The history, architecture, and beauty of this city are constant sources of inspiration to me as a Certified Interior Decorator," Jonathan says, as are his extensive international travels and love of art.

His firm, Atelier Jonathan Senner, believes in creating timeless interiors that are both modern and classic. Jonathan is best known for crafting curated spaces using one-of-a-kind,

often vintage pieces that reflect his clients' style and combine harmoniously into a unified vision. He also loves to incorporate color with unique statement pieces and to juxtapose eclectic furnishings and décor against historical interiors and architecture.

Atelier Jonathan Senner always puts the customer first by fostering a relationship-oriented approach to ensure transparency, open communication, and mutual understanding, while helping its clients transform their personal environments.



JONATHAN SENNER, C.I.D.
ATELIER JONATHAN SENNER

Washington, DC 20003
202-577-1141
jonathansenner.com



AREA 4 CHINA PANTRY

This modern day “China Pantry” embraces the warmth, civility and charm of Old World entertaining and encourages and celebrates the art of conversation. Our vision for the Butler’s Pantry is admittedly a complete indulgence, but what a treat to have a pantry dedicated to the storage and display of your favorite dishes, glassware and linens. The room is imagined as a restful place to linger and plan parties and gatherings as well as an organized central storage to easily choose from collections of china, stemware, serving pieces and table decor. Our design uses saturated and textured color, including custom vintage aqua Wood-Mode cabinetry paired with Farrow and Ball’s “Ranelagh” wallpaper on the ceiling. An antiqued, mirrored chandelier from Circa Lighting and soft brass touches complete our built-in finishes. Layers of china, stemware and serving pieces fill the space - just waiting to be chosen for the next special event. Special thanks to trade partners R. Bratti, Billet-Collins and Goldsborough-Glynn for helping bring our vision to fruition.



Ranelagh 1847
Stony Ground 211

ABOUT THE DESIGNERS

NADIA N. SUBARAN & MEGAN M. PADILLA

After 18 years in custom kitchen design, Nadia Subaran is still as passionate as ever about creating thoughtful living spaces that enhance the daily lives of her clients while reflecting their character and lifestyle. Nadia has a Bachelor of Architecture degree from The Cooper Union in NYC and founded Aidan Design with her husband, John A. Schmiedigen, in 2002.



A growing love for design and interest in shaping interior spaces led Megan Padilla to pursue a career change in 2008. She earned an M.F.A. in interior design from George Washington University in 2010 and joined Aidan Design in 2011, after a stint as a design lead with a DC-based luxury real estate developer.

Aidan Design has been honored with a number of design awards – most recently *HOME&DESIGN* magazine’s 2016 Designers’ Choice Award for Favorite Kitchen Design Firm – and has been featured in *Washingtonian*, *Traditional Home*, and *Kitchen Trends*, among other publications.

NADIA N. SUBARAN & MEGAN M. PADILLA AIDAN DESIGN

8935 Brookville Road
Silver Spring, MD 20910
301-320-8735
aidandesign.com

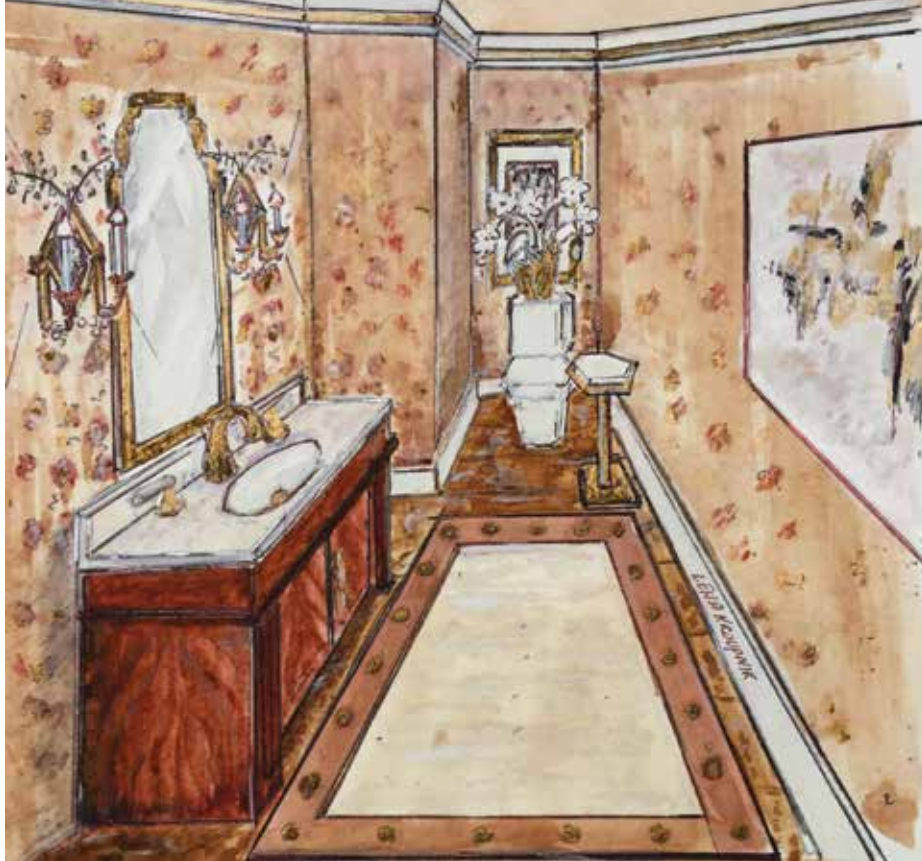

AREA 5 POWDER ROOM

Think glamour, allure, and enchantment with a touch of animal magnetism perfectly packaged into a small, elegant powder room. It all starts with the spectacular, dramatic “Russian Sconces” from Niermann Weeks, which flank the elongated, gold-leaf mirror. The sconces are the focus of the space and evoke memories of world travel through magnificent St. Petersburg and French estates. A gorgeous painting, called “La Mémoire XI” by Nurieh Mozaffari (Susan Calloway Fine Arts), adorns the opposite wall, finding its reflection in the mirror. A black-white contemporary painting by Maryanne Pollock adds a bold, unexpected touch to the traditionally styled space. This beautiful space is the confluence of function and style. We enhanced the beauty of an existing Empire-style vanity with animal print wallpaper by Farrow and Ball, a painted ceiling, and a hand-made key tassel, created by Victoria Fahardo, featuring light aragonite and black onyx semi-precious stones. Do not miss the other gems – a crystal faucet, a small octagonal marble table, and a custom soft rug by Carpet Creations.



Ocelot
3703



Elephant's
Breath 229

ABOUT THE DESIGNER

LENA KROUPNIK, NCIDQ

Russian-born Lena Kroupnik was drawn to interior design, which allows her to combine her initial Master Degree as Engineer-Electro-Physicist with her inherent artistic creativity. Lena blends her profound knowledge of practical and theoretical elements with a deep understanding of scale and balance, allowing her to create spaces that withstand the test of time as well as changing trends.

Creating interior environments that reflect the needs and personalities of the clients is key to her business

philosophy. On every project, Kroupnik utilizes her space-planning skills to either improve upon an existing space or design new construction. Her refined sense of color often brings an element of surprise to her interiors. She likes to repeat “thread” colors throughout the space. “It takes a village,” says Kroupnik, stressing the importance of collaboration with clients, architects and contractors. “It is absolutely necessary for the success of every project.”



LENA KROUPNIK, NCIDQ
LENA KROUPNIK
INTERIORS, LLC

240-505-6783

lenakroupnikinteriors.com



AREA 6

A COZY, CORAL FAMILY ROOM

Inspired by blue and white porcelain collected from world travels, the pretty and practical family room is infused with coral accents for a modern take on a classic color combination. With a focus on function, the space is designed for the entire family's enjoyment – from the game table to the seating arrangements to the TV. A custom dog bed makes sure the family pet has a personal spot, too! The pretty elements include Schumacher's Plaisirs De La Chine fabric in bleu and rouge on the wing chair and the pillows along the blue ultrasuede sofa. Coral Pearson club chairs, with navy and white Jonathan Adler trim, and a Michael Cleary glass and wood display cabinet, with coral leopard print wallpaper lining the back, bring the accent color into full play. Additional pillows featuring Fabricut and Christopher Farr Cloth textiles, as well as draperies in a Clarence House fabric with horizontal blue and white stripes, enhance the beauty of the space. A custom treatment envelops the walls, while Schumacher's Abstract Leaf wallpaper in Dove crowns the ceiling, creating a cozy, pretty and practical family room.

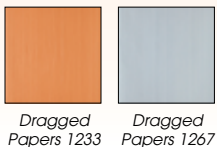

ABOUT THE DESIGNER

KELLEY PROXMIRE

Participating in her 24th show house in 15 years, Kelley Proxmire brings a passion for interior design that began in her pre-teen years as she observed interior designers transform her parents' home. She went on to study the work of classic greats such as Billy Baldwin, laying the foundation for a design style that incorporates pretty yet practical elements.

In her 20-plus-years career, Kelley has developed a matchless eye for crafting tailored traditional interiors,

exuding warmth and hospitality while maintaining excellent balance, proportion and scale. Her love of color is combined with an appreciation for the sophistication of white and the elegance of black. Adept at mixing traditional pieces with unexpected finds, Kelley creates environments that are attuned to the client's world and faithful to the architecture and setting of a home. Kelley was named the 2016 Designers' Choice Hall of Fame Designer by *HOME&DESIGN Magazine*.



KELLEY PROXMIRE
KELLEY INTERIOR DESIGN

4519 Wetherill Road
Bethesda, MD 20816
301-320-2109
kelleyinteriordesign.com

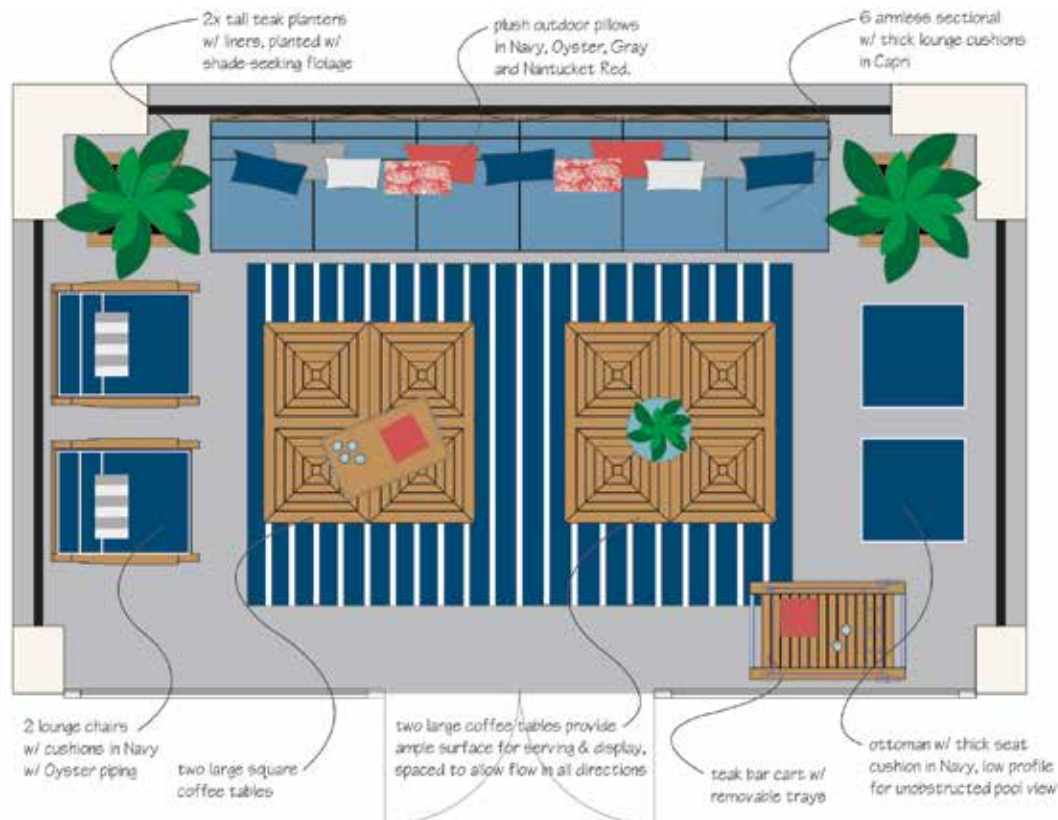

AREA 7 TERRACE

Inspired by the idea of the terrace as an extension of the family room, I created an ideal place to relax with family and friends amidst the trees. Keeping comfort in mind, the seating provides a variety of lounging options utilizing teak outdoor furniture with thick, cushioned seats in outdoor performance fabrics. An expansive sectional, with room for eight (or just a few sprawled out), is anchored by two teak lounge chairs on the left and two ottomans on the right. The lounge chairs feature elegant, demilune-shaped backs and armrests that mimic the curve of the terrace ceiling. The opposing ottomans offer low-profile seating options that give a perfect view of the pool below. Two beautiful, geometric coffee tables in natural teak provide generous room for serving, gathering or display, while the bar cart keeps all libations and accessories close at hand. The space is framed on either side by floor-to-ceiling, striped curtains and two tall, sleek planters with billowing foliage. All furniture is from Country Casual Teak.

ABOUT THE DESIGNER

KIMBERLY ASNER

Kimberly Asner graduated from Auburn University with a Bachelor's degree in Industrial Design, and has been with Country Casual Teak as a Furniture Designer for eight years. She has designed over 70 pieces of outdoor furniture for Country Casual Teak, 11 of which have protected design patents. Kimberly's designs bring style, function and joy to people across the U.S. She's become an expert on this rare and highly sought-after material – teak wood – and the ways

it can be used to bring beauty and comfort to any outdoor space.

Over the past 40 years, Country Casual Teak has been the nation's leading specialist in teak outdoor furniture for homeowners and businesses alike. Headquartered in Gaithersburg, MD, Country Casual Teak provides quality products with strict standards of excellence and exceptional customer service. The company is continually launching new and exclusive products, expertly constructed to be enjoyed for decades to come.



KIMBERLY ASNER
COUNTRY CASUAL TEAK

7601 Rickenbacker Drive
Gaithersburg, MD 20879
800-289-8325
countrycasualteak.com



AREA 8

THE LIBRARY AND WHISKEY BAR

Welcome to the library and whiskey bar -- a room traditional in feel, yet also comfortably modern. Our overall interest was to bring warmth, texture, patina and the eclectic to a staid, recently constructed space. The walls and existing bookcases are joined into a harmonious whole with a cedar-toned jute wallcovering. Celadon ceilings set off a remarkable Baltimore-artisan chandelier while the bookcases are backed in a Dijon-toned textured finish. Inspired by English apple rush matting, the soft jute rug was selected to both lighten and contrast with the woodwork. An extraordinary, circa-1760, French verdure tapestry conceals a garage-door-like feature and offers a "trompe l'oeil" woodland view. The artwork is a contemporary counterpoint, engaging without aggression. The furniture selections are a mix of materials, styles and periods that range from an exceptional pair of signed Maison Jansen tables to modern pieces that reflect the best of current craftsmanship. Our two seating areas and secret whiskey bar collectively invite rest, comfort, and conversation.

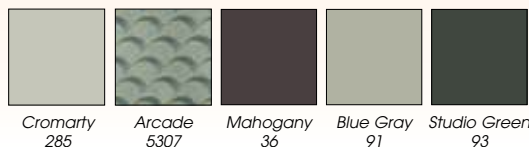

Cromarty
285

Arcade
5307

Mahogany
36

Blue Gray
91

Studio Green
93

ABOUT THE DESIGNERS

Josh Hildreth & Victor Sanz

Josh Hildreth was born in New York and raised in the Midwest. He pairs a studied, passionate interest in design history with a warm and engaging interpersonal style. His layered, personal spaces convey a sense of attentive collecting over spans of time. His design approach values the quiet sophistication of detail, subtlety & suitability, bringing together a gracious mix of old and new, classic and contemporary, in a way that feels fresh and relevant without veering into trendy.

As the founder of a successful 11-year-old, Washington DC-based, commercial interiors firm, Josh delivers projects with excellent project management skills and a deep knowledge of construction and interior architecture. Josh is joined by Victor Sanz, an architect from Madrid currently working in Washington. Victor has collaborated on projects throughout Europe and South America, and brings a distinct global perspective to interior architecture and room design.



**JOSH HILDRETH
& VICTOR SANZ**
DMG INTERIORS
JOSH HILDRETH INTERIORS

11130 Sunrise Valley Drive
Reston, VA 20191
804-239-8155
dmginteriors.com



AREA 9 LIVING ROOM

Taking cues from the home's classic architecture, I envisioned a living room that evokes timeless elegance and subtle glamour. The room's color palette of black and white with striking pear green accents sets the tone. The symmetrical bones of the room encouraged a balanced floor plan, perfect for entertaining. A black-lacquer, baby grand piano, paired with an upholstered, skirted bench plays host to a pair of painted Italian peacocks. Paper white sofas, covered in party-proof Sunbrella fabric, are accented with pillows in Grey Gardens floral and a textured cheetah, both by Schumacher. The exquisite vintage Hollywood Regency ottoman boasts a graphic cut velvet, also by Schumacher, adding a stunning presence opposite the fireplace. Flowing black drapery panels, hung on an acrylic rod with brass rings, pop against the crisp white walls. Strong black finishes with subtle golden accents anchor both the cocktail table and desk. The French writing desk, paired with a citron velvet chair, adds interest. Gilded butterfly sconces encased in a backlit acrylic box serve as both art and ambient light for the space.

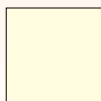

Painting
2003

ABOUT THE DESIGNER

PAMELA HARVEY

Designed for Living is more than a slogan for Pamela Harvey's full-service firm; it's a design viewpoint that informs her work. Pamela and her team create sophisticated interiors that are as functional as they are polished. Understanding her client's lifestyle is a critical path in her design process. Pamela truly believes that her clients should receive the absolute best design for the very best value. It's a classic win-win situation that leaves everyone feeling fabulous with the end result.

Pamela describes her

style as "new-traditionalist." She combines the formal training of her degrees in psychology and interior design with her background in fashion to create rooms that are casually elegant.

Pamela's work has appeared in *HOME&DESIGN* magazine, *Romantic Home*, *Northern Virginia Magazine*, *Washington Spaces* and *The Washington Post*. This is Pamela's second time participating in the DC Design House. She has also participated in the Washington Design Center Showhouse.



PAMELA HARVEY
PAMELA HARVEY
INTERIORS, LLC

Oakton, VA
703-787-6692

pamelaharveyinteriorsllc.com



AREA 10 MASTER BEDROOM SUITE

Luxury is best found in a master bedroom. Time should stop. Sound should be absorbed for total calm. A haven within a haven should be created. For this soothing, tranquil retreat, we selected a color scheme with the palest of blues and creams. Comfortable furnishings, with a mix of antique upholstery and gilded touches, arouse the senses. Selections for this special master bedroom include an upholstered headboard surrounded by a tailored canopy, an antique French chaise lounge at the foot of the bed, classic lounge chairs that offer a view to the exterior balcony, and over-scaled contemporary art in shades of blues and creams that add quiet drama in this light-filled, airy suite.

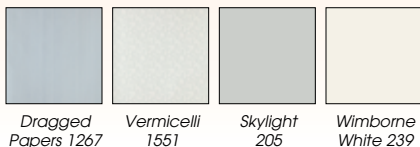

ABOUT THE DESIGNER

VICTORIA SANCHEZ, ASID, NCIDQ, IFDA

A native of the Washington, DC area, Victoria Sanchez began her career over 30 years ago. Specializing in residential design, Victoria's expertise extends to renovations and new construction. Her work incorporates unlimited colors, patterns, and finishes while respecting design principles.

Victoria's latest achievement is her own store, recently opened in the heart of charming Old Town, Alexandria. VICTORIA AT HOME reflects the casual elegance for which

she is known, offering her customers the lines of high-end upholstery and accessories that she's sourced for her private clients for years.

Victoria has both an undergraduate and master's degree in interior design from Marymount University in Arlington, VA. She also enjoys teaching interior design courses at local colleges. She was recently selected as a "Style Maker" by *Luxe Magazine* and her work has been showcased in numerous show houses and magazines.



VICTORIA SANCHEZ
VICTORIA AT HOME, LLC

1125 King Street
Alexandria, VA 22314



AREA 11 BEDROOM #2

The main color inspiration for this room is orange. It reminds me of dramatic sunrises and sunsets. It gives a cheery feeling at dawn and an embracing warmth at dusk. The orange striped wallpaper creates this backdrop for the bedroom. Adding visual interest to the room is the Chiang Mai Dragon fabric. The stylized Asian inspired pattern is whimsy with a touch of glamour. It can be seen layered against the wallpaper as drapes and as a highlight of the room on the headboard. A custom Moroccan rug in colors, inspired by the Chiang Mai Dragon fabric, is laid over a sisal rug adding warmth and grounding the bed and surrounding room. A pair of Art Deco inspired side tables with green porcelain table lamps flanks the bed, creating a sense of symmetry. Antiqued brass finishes on the metal elements, such as the chandelier, lamps and étagère, add just enough touch of elegance to the bedroom.

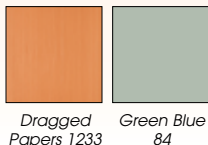

ABOUT THE DESIGNER

CHARLES C. ALMONTE, AIA, ASID

Charles C. Almonte provides architecture and interior design services to clients looking to enhance their built spaces according to their lifestyle and taste. Services include additions, renovations, space planning, furniture, fixture and finish selections and color consultations. He helps clients create residential spaces with timeless appeal, mixing modern and classic elements with traditional interior design principles to create composed environments. He maintains a clean aesthetic that is fresh and inviting.

Charles is a registered architect and certified interior designer. He has over 10 years of professional practice in the field of architecture, interior design and historic preservation. His experience in architecture and knowledge in historic preservation also allow him to create interior spaces that bridge the exterior architecture to the interior. He is a member of the American Institute of Architects and American Society of Interior Designers.



**CHARLES C. ALMONTE,
AIA, ASID**
**CHARLES C. ALMONTE
ARCHITECTURE /
INTERIOR DESIGN**

9913 Grayson Avenue
Silver Spring, MD 20901
202-492-8494
charlesalmonte.com



AREA 12 LOFT

The third floor loft is an intimately scaled space, which provides an ideal area to use for lounging, reading and general relaxation. With these uses in mind, we selected a palette of blues and whites to evoke refined coziness. Bold navy walls provide stunning contrast to the white linen sofa, *étagère*, and artwork, while the rich, off-white rug adds additional balance to the depth of the wall color. The clean lines of the furnishings keep the room from becoming visually cluttered and allow for the leopard and ikat pillows, sconces and decorative accessories to pop. The nook in this room was a challenge but also an opportunity. Though it is not large enough for a seating piece, it provided a fantastic space to use a bold wall covering. We selected a printed grass cloth in hues that accent our room and applied it to the walls and ceiling. Framing the nook in gorgeous, navy linen draperies draws attention to this sweet space and really makes it a special part of the room.



Stiffkey Blue
281

Borrowed
Light 235

ABOUT THE DESIGNERS

MELANIE HANSEN, STEVE CORBEILLE & POOJA MITTRA

Steve Corbeille, Owner and Principal, purchased the family-owned firm in 1988, after his father's retirement. Over the past 28 years, Steve has expanded Yardstick Interiors' offerings and grown its client base throughout the DCMV.

Melanie Hansen joined Yardstick as Director of Commercial Design and Senior Designer after spending four years design-

ing VIP spaces aboard aircraft carriers. Prior to working with the Navy, Melanie worked for a residential firm in Seattle.

With a background in civil engineering, Pooja Mittra found her true passion in interior design. She began her career mastering the retail side of design through Kravet and Lee Jofa, and eventually joined Yardstick Interiors as Creative Partner, specializing in residential design.



MELANIE HANSEN, STEVE CORBEILLE & POOJA MITTRA
YARDSTICK INTERIORS

301-349-3449
yardstickinteriors.info



AREA 13 VINTAGE CABANA/ROOF DECK

An invigorating botanical wallcovering takes your senses straight to our modern-day dry bar, perhaps to grab a refreshing martini before heading to the outdoor space inspired by the vintage Hollywood glam of the Beverly Hills Hotel. We married these two spaces together by taking the existing wainscot design on the outer walls of the roof deck right into the interior space. We painted the entire detailing in Farrow & Ball Wimborne White, making this a cohesive and charming architectural design element. In the outdoor area, we created a custom canopy over a slip-covered split-back sectional. Custom details, such as the bench cushion for comfort, the pineapple finials, and the bold contrasting palm-leaf drapery, make this the focal point of our design. For added charisma, we chose a flooring installation with a fabulous modern take on parquet floors. Everyone loves a cool roof deck! This space was designed to encourage guests to stretch out, restfully enjoy their drinks, and engage in great company and good conversation.

ABOUT THE DESIGNER QUINTECE HILL-MATTAUSZEK

After collaborating with other designers since 2002, Quintece Hill-Mattauszek established her own, full-service interior design firm in 2011. Studio Q's detail-oriented and client-focused approach to design guides clients to better design decisions that make their home uniquely theirs.

With a degree in interior design and certification in computer aided design (CAD) software, Quintece brings her 14 years of creative and technical design skills to each and every project.

She prides herself in her ability to transform her client's design goals and challenges into beautiful, bold, and functional spaces. Quintece takes extreme care in making sure every design project reflects the client's distinct lifestyle.

Studio Q is a Virginia-based design firm that operates in the Washington D.C. and Baltimore metropolitan areas. Quintece has been previously featured in the home section of *The Washington Post*, *Baltimore Sun*, and social media blog *Design Minds*.



**QUINTECE
HILL-MATTAUSZEK
STUDIO Q DESIGNS**

Alexandria, VA
301-728-2343
studioqdesigns.com



AREA 14 CHIC RETREAT

Envision my client to be a confident, well-traveled woman who knows what she likes and wants. She is family-centered with an exciting career and rewarding personal life. The Chic Retreat is her special getaway, a place to take care of business and a quiet hideaway for reading and relaxing. Her favorite things are at her fingertips, and she is surrounded by color, meaningful collections and comfort. Bespoke, custom furnishings, designed by Barbara Brown and exquisitely made by Summerhill Cabinets, set the tone for a unique, layered, one-of-a-kind space. A modern take on classic chinoiserie is the inspiration behind Barbara's design of the cabinet, desk, and custom wall motif, which is beautifully executed by Cunningham Studios. A dazzling chandelier and chair by Niermann Weeks add sparkle and detail, while a curated mix of fabrics, custom drapes, pillows, and accessories provides the all-important finishing touches. The Chic Retreat is a perfect space for this #GIRLBOSS.

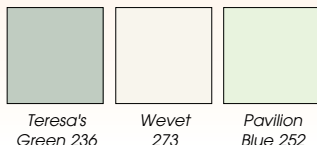

ABOUT THE DESIGNER

BARBARA BROWN

Barbara Brown grew up in New England with a mother who loved interior design. "If you stood still in the house where I grew up, my mother would paint you!" Her full service design studio marries formal design training, 25 years of experience, and a passion for providing excellent design.

Client Centered Design is Barbara Brown Interiors' design philosophy. A full understanding of the client's lifestyle and preferences is what drives each design. An effective

process that is enjoyable, stress free, and transparent is employed. She is an expert at creating curated, dynamic, interiors on time and on budget, whether an entire house renovation or one room. Excellent service is a priority and working with clients is a privilege.

Barbara has participated in several show houses, and has been featured in the *Baltimore Sun*, the *Washington Post*, and WBAL-TV. She is honored to participate in her first DC Design House.



BARBARA BROWN
BARBARA BROWN
INTERIORS, LLC

443-340-9759
bb@barbarabrowninteriors.com



AREA 15 CHIC RETREAT- DRESSING ROOM & BATH

Within the Chic Retreat, the dressing room and bath continue the elegance. An ethereal silvery wallpaper by Farrow & Ball acts as a neutral bridge between rooms while softening the angles of the space. Favorite jewelry, perfume, the perfect bag -- all are at the ready so that going from work to play is a breeze. Glamor, gilt, and mixed metals are introduced with two martini tables and a gorgeous cigarette table, all by Century Furniture. I call items as special as these "room jewelry." They are beautiful and add gravitas to any space. Curated artwork from Susan Calloway Fine Arts and a striking mirror from Niermann Weeks complete the dressing room. Green and creamy-white Farrow & Ball wallpaper is the star of the bath. Adding crown molding finishes the space, while sparkling sconces and a stunning mirror provide the finishing touches. The greens and blues of the bath tie beautifully with the rest of the suite, providing continuity and flow without being overly matched.



Peony
2303

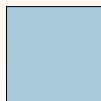

Lulworth
Blue 89



Tessella
3607

ABOUT THE DESIGNER

BARBARA BROWN

Barbara Brown grew up in New England with a mother who loved interior design. "If you stood still in the house where I grew up, my mother would paint you!" Her full service design studio marries formal design training, 25 years of experience, and a passion for providing excellent design.

Client Centered Design is Barbara Brown Interiors' design philosophy. A full understanding of the client's lifestyle and preferences is what drives each design. An effective

process that is enjoyable, stress free, and transparent is employed. She is an expert at creating curated, dynamic, interiors on time and on budget, whether an entire house renovation or one room. Excellent service is a priority and working with clients is a privilege.

Barbara has participated in several show houses, and has been featured in the *Baltimore Sun*, the *Washington Post*, and WBAL-TV. She is honored to participate in her first DC Design House.



BARBARA BROWN
BARBARA BROWN
INTERIORS, LLC

443-340-9759
bb@barbarabrowninteriors.com
barbarabrowninteriors.com



AREA 16

MADEMOISELLE CHAMBRE

Stepping into the Mademoiselle Chambre transports guests to the très-chic city of Paris. The muse for our design is a French ingénue with diplomatic parents looking for worldly sophistication. With a childhood spent in Paris, our imagined inhabitant is accustomed to high fashion and elegant style. She also loves a little sparkle and shine. Our goal was to create a timeless bedroom design that a between-two-worlds teenager can enjoy for years to come. The girly-yet-glamorous space balances sophisticated furnishings with playful touches, floral accents and reflective surfaces. The grown-up bed sets the tone, with its headboard combining white faux leather and crystal tufting. The practical and oh-so-pretty white armoire features a geometric and flower motif. The floral theme continues in the painterly linen window panels and the swags adorning the shimmering wall covering with tone-on-tone, sugary circles. Against the predominantly white backdrop, pops of pink – from the lounge chair pillow fabric to the ceiling paint – lend feminine charm. A flowery crystal chandelier adds a bit of bling overhead.

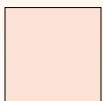

Calamine
230

ABOUT THE DESIGNER

ANDREA HOUCK, ASID, IFDA

Andrea Houck has been “creating spaces you will love...traditional, modern or somewhere in between” for over 16 years. She helps clients articulate what they love and how they live. The end results are personal, beautiful and functional.

While every design is tailored to the client, common threads unite Andrea’s work – an artful mix of materials and motifs, an innate understanding of scale and balance, and well-thought-out lighting plans. Andrea considers the interior architecture of the space and ensures

that those elements – from fireplace treatments to storage solutions – are given attention up front.

Andrea participated in the 2013 DC Design House, conjuring the French Modern Bar and Side Hall. Her work has appeared in numerous publications, including *HOME&DESIGN*, *Arlington Magazine*, and *The Washington Post*. In 2016, Andrea received the ASID Award of Excellence for a family room project. She shares her passion with *Creating Spaces*, a blog about design.



ANDREA HOUCK
A. HOUCK DESIGNS, INC.

703-237-2111
ahouckdesigns.com



AREA 17 THE CHIC LAUNDRY ROOM

Wash. Dry. Fold. Repeat. The Chic Laundry Room is not merely a place to sort and fold; it presents a moment to stop, breathe and restart. The most memorable days often end with the dirtiest clothes so why not have a sleek and sophisticated laundry room to tackle this task, a place where design trumps utility. Whether you have one or ten loads awaiting, the light and airy palette makes this chore more enjoyable. The sink doubles as a spot to cut flowers while the ample counter space lends itself to folding clothes as well as craft or fix-it projects. Not your grandmother's laundry room, this Chic Laundry Room offers a classic design that will last longer than the piles!

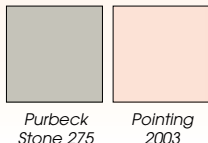

Purbeck
Stone 275

Pointing
2003

ABOUT THE DESIGNER

ALLIE MANN

With a B.F.A. in interior design, Allie Mann is a member of the American Society of Interior Designers as well as a Certified Kitchen and Bath Remodeler and Certified Aging in Place Specialist. She is a past DC Design House participant and was recognized in 2016 by HGTV as a Fresh Faces of Design Finalist. Allie specializes in creating comfortable, yet elegant spaces. In addition to designing stunning rooms for her clients, she has a passion for teaching and serves as

an adjunct faculty member at Northern Virginia Community College.

Case Design/Remodeling, Inc. is the area's largest full-service residential remodeling firm with a focus on excellence, quality and value. Case, which has been honored with more than 100 awards for design, craftsmanship and ethics, is celebrating its 55th year along with a new design studio on 14th St., NW, in Washington DC.



ALLIE MANN, DESIGNER
**CASE DESIGN/
REMODELING, INC.**

MD, DC, VA
301-229-4600

casedesign.com



AREA 18 LADY LAIR

The Lady Lair is her answer to the Man Cave—where she goes to steal-away, unwind, recharge. The ideal get-away would be open, with lots of light and majestic views. But this room, long and narrow, with thin streams of light coming through a rhythm of dormered windows, posed a challenge. It reminded me of being in a Pullman car when I first saw it. So I just went with the image of a 1st class ticket on the Orient Express. I wanted this room to be transporting, as if one literally arrived elsewhere upon entry. A mix of motifs from the Far East, the Subcontinent and Europe found in the artwork, fabrics, finishes, fixtures and furnishings helps to set this tone. The bar, tucked into an otherwise awkward closet, has the feel of a glam speakeasy. And to tip the luxury meter a wee bit over the top, there's an "echo of Deco" in all the custom furniture designs. She need only go down the hall for her retreat. All aboard!

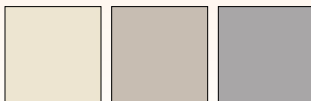

Skimming Stone 241
Elephant's Breath 229
Dove Tale 267

ABOUT THE DESIGNER

RACHEL DOUGAN

Rachel Dougan's design aesthetic evolved from living in Asia and Europe for many of her formative years as well as her education in graphic design and a former career in branding strategy and design. She began her second career in interiors working with the late Washington designer, Jerry Copeland, before she founded ViVi Interiors in 2016.

Vivi means "living" in Latin, which aptly sums up how Rachel approaches design. She believes that having a well-designed home goes

beyond what's fashionable to truly supporting and enhancing the lifestyle of those who live in it. She says, "A daily routine can be a mini-celebration if you set it up to be so—like a terrace off the bedroom with a coffee bar and wine cooler within reach, or a reading nook in the quietest part of the house, or a full-on hamam in place of the attic. Whether the gestures are small or grand, every day can be an opportunity to live it up!"



RACHEL DOUGAN
VIVI INTERIORS

Washington, DC
202-725-6526
viviinteriors.com



AREA 19

KITCHEN/BREAKFAST ROOM

The original kitchen is a large and bright room. I wanted to keep the usefulness and simple utility that the original design presented as well as maintain a comfortable and spacious feeling. I continued the neutral color palette set with the existing cabinetry, millwork and stone, but added a soft teal and other complementary neutrals to bring the outdoors inside. The fabric chosen for the seating is tough and stain-resistant. I intended the gorgeous Farrow and Ball wallpaper on the ceiling to suggest clouds in the sky, accentuating the 11 foot ceiling height. The spectacular furniture from Thomas Moser adds an element of classic modern architecture to the space; as well as bringing the rich, handmade tactile quality of wood to the room. Pluntke Decorative Painters created a wall texture that blends all the elements in the room with a durable and beautiful finish. The modern and dramatic fixture (from Niermann Weeks) over the island is beautifully complemented by the sculptural bronze chandelier (from David latesta) over the dining table. Hartmann and Forbes natural fiber Roman Shades help to evoke the feeling of the outdoors.



Tourbillon
4805



Mahogany
36



India Yellow
66

ABOUT THE DESIGNER

BETSY BARMAT STIRES, ASID-ALLIED

Betsy Barmat Stires has been an interior designer for more than 20 years. A graduate of Lehigh University, she enjoys bringing to clients' homes her sensibility for clean classic interiors built with a variety of textures, good proportions, quality furnishings

and interesting art. Betsy specializes in interior architectural details.

Betsy has participated in two recent show houses on Mount Desert Island, ME. Her Maine cottage was recently featured on the cover of *Maine Home and Design Magazine*.



BETSY BARMAT STIRES, ASID FROG HILL DESIGNS, LLC

400 Madison Street, No.501
Alexandria, VA 22314
froghilldesigns.com



AREA 20

SITTING ROOM - LA SALON DEL CELEBRITY

With a mix of classic lines and modern forms, Camille Saum stays true to her timeless nature in the design of this room. Simple, modern furnishings from Beverly Furniture and Hollis & Knight are beautifully layered in neutral tones with pops of color and variations in texture. The space is a study in scale and variety. The windows are dressed in Hartmann & Forbes shades and textural burlap draperies embellished with fringe (thanks to Everett Design). The fireplace features pearlescent tile supplied by Best Tile and a screen customized by Design Weld Metals (with design consultant Mike Spiegall Glass Company). The impressively dramatic area rug is courtesy of Doris Leslie Blau. The focal point of the room is the celebrity caricatures hand-painted by the talented Ali Nassari Atelier. Farrow & Ball paint colors, Abrielle Fine Linens and artwork from Merritt Gallery are featured in this space, as well as superior installation expertise from Rohan Hutchison, Hann & Hann, and J Lambeth. Special thanks to Madeleine Mitchell and Becky LaRoche.

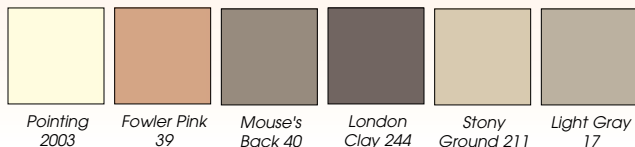

ABOUT THE DESIGNER

CAMILLE SAUM, ASID

A native of Washington DC, Camille Saum, owner of Camille Saum Interior Design LLC, is guided by the principle that "good design is timeless." For over 20 years, Camille has created a myriad of living environments with elements that range from quaint and romantic to refined and practical elegance. Camille specializes in full service design from concept through construction until the last detail is in place.

National and local acclaim has created a demand for Camille's timeless design. Her

discerning residential and commercial clients find their design expectations met in rooms of distinction, high style, and comfort. Camille's ability to turn her clients' visions into unique expressions that illustrate their lifestyles has fostered her reputation as a noted design professional. She brings a level of sophistication to each design with an unerring sense of color and texture mixed with her characteristic flair for opulence, drama, whimsy, and the unexpected.



CAMILLE SAUM, ASID
CAMILLE SAUM
INTERIOR DESIGN, LLC

4949 Saint Elmo Avenue
Bethesda, MD 20814
301-657-9817
camillesaum.com



AREA 21 FORMAL IN THE WOODS - LOWER GARDEN

The lower garden to the left of the flagstone terrace had potential but lacked character equal to the architecture of the home. We concluded that a formal design would best complement this space. The garden is planned so that guests can view it from the rooms above, then enter the backyard space from the lower level terrace to experience its design and tranquility. The design of this garden room uses formal, clipped hedges bordering a lawn panel to contrast the natural wooded area behind it. Granite cobblestones edge the lawn and define the space. A fountain serves as the central focal point creating intrigue and reflection. A unique curved teak bench, reinforcing the lawn panel outline, offers a place to pause and enjoy the view. Four large planters, filled with fall seasonal color, anchor the corners of the hedge. Shade garden plantings, such as fall flowering Japanese Anemone and Chelone, add color to the garden. Accent shrubs, Viburnum x Pragense and Oakleaf Holly, soften the formal lines of the lawn panel.

ABOUT THE DESIGNERS

STEPHEN WLODARCZYK & JOSHUA DEAN

Stephen Wlodarczyk is a professional landscape architect with over 18 years of experience in the Washington DC area. He holds a BS in landscape architecture from West Virginia University. Stephen's love for the outdoors and keen eye for design have developed a successful residential landscape, design-build career. Stephen specializes in creating beautiful outdoor living environments for his clients. His achievements include grand awards from the Landscape Contractors Association and a national award from the Association of

Landscape Professionals.

Joshua Dean is an award-winning landscape designer who focuses on large-scale, residential design/build projects. Dean is known for finding the best quality specimen plantings to accent his elegant stonework. A graduate of The George Washington University's landscape design program, he also holds a Master of Fine Arts in creative writing from George Mason University. *The Washington Post*, *The Wall Street Journal*, *Curb Appeal*, *Indoors Out*, and *Ask This Old House* have all featured his installations.



**STEPHEN WLODARCZYK
& JOSHUA DEAN**
**WHEAT'S LAWN &
CUSTOM LANDSCAPE**

8620 Park St Vienna, VA 22180
703-641-4792
wheats.com

INDEX OF SOURCES

Area 1**FRONT GARDEN & PORCH**

Blake Dunlevy & Gina Palmer
D & A Dunlevy Landscapers, Inc.

RESOURCES All craftsmanship provided in house by D & A Dunlevy Landscapers, Inc.

Area 2**ENTRY, HALL AND BACK STAIRS**

Eve Fay
Farrow & Ball

RESOURCES Wallpaper: Farrow & Ball; Paint: Farrow & Ball; Carpet: Stark Carpet; Lighting: Circa Lighting; Artwork: Merritt Gallery; Console Table: Century Furniture; Teak Bench: Century Furniture; Planters: Century Furniture; Reception Chairs: Thos. Moser

SPECIALISTS Paper Hanger: F.L. Emory & Sons; Painters: Living Spectrum

Area 3**DINING ROOM**

Jonathan Senner, C.I.D.
Atelier Jonathan Senner

RESOURCES Armchairs (Vintage): Chairish; “Bistro” Sconces by Ian K. Fowler and “Star” Sconces by Eric Cohler: Circa Lighting, Georgetown; Bronze Sculptures: “AM SUNDAY” (on pedestal) and “CREATION” (on credenza), both by Larry Schueckler courtesy of Merritt Gallery, Chevy Chase, MD; “Cassons” Settee Silk in Black and White and “Alchemy Gimp” Trim in Onyx: Beacon Hill/Robert Allen, WDC; “Cheetah Velvet” Armchair Pillow Fabric in Black and White: Beacon Hill, WDC; Credenza (Vintage): Chairish; Custom “Triumph” Dining Tables: Keith Fritz Fine Furniture; Dining Benches (Vintage): Istdibs; Drapery Hardware: Gretchen Everett; Floor Lamp (Vintage): One Kings Lane; “Glass Paneling” Ceiling Paper: Miles Redd for Schumacher, WDC; “La Cité” Wallcovering: Schumacher, WDC; “Lady Elsie” Armchair Velvet in Evergreen and “Spectrum” Mini Cord in Pearl: Beacon Hill/Robert Allen, WDC; “Marquis” Bar: Mitchell Gold + Bob Williams, Washington, D.C.; “Mulberry” Drapery Silk in Forest and “Greek Key Braid” Trim in Billiard Green: Beacon Hill/Robert Allen, WDC; “Mustafa” Dining Bench Fabric in Ebony: Beacon Hill, WDC; “Nala Collection” Area Rugs: Stark Carpet, WDC; Paint: “Slipper Satin” and “Pointing,” both by Farrow & Ball; Semi-Precious Stone Decorative Boxes: Jacob-Lukas, Ltd.; Settee (Antique): One Kings Lane; Side Chairs (Vintage): Istdibs; Side Table: Restoration Hardware; “Splash” Side Chair Faux Leather in Camel: Robert Allen, WDC; “Strada” Chandeliers by Kelly Wearstler: Circa Lighting, Georgetown; “Watteau” Mirror: Schumacher, WDC; White Quartz Napkin Rings: Crystal Luxe Lighting, Bethesda, MD

SPECIALISTS Art Consultation: Anne-Marie Arkwright, Merritt Gallery; Custom Drapery: Gretchen Everett; Custom Pillows and Upholstery: Rockville Interiors, Inc.; Lighting Installation: Foxcraft Design Group, Inc.; Painting: John Mahoney; Rendering: Hannah Weber; Wallcovering and Ceiling Paper Installation: Michael DiGuseppe

Area 4**CHINA PANTRY**

Nadia N. Subaran & Megan M. Padilla
Aidan Design

RESOURCES Cabinets: Wood-Mode’s “Lancaster Recessed Square” door style in custom Vintage Aqua finish with Antique English hinges through Aidan Design; Cabinet accessories: china, crystal, silver, glassware and tabletop décor by Goldsborough Glynn Classic Furnishings & Finds; Cabinet hardware: Atlas Homewares “It” pull in Vintage Brass through Aidan Design; Countertop: Sea Pearl Quartzite by R. Bratti Associates; Custom hand painted decorative accessories: Floor cloth, decorative plates and table linens by Billet Collins. Lighting: “Lido” Medium Chandelier by Niermann Weeks through Circa Lighting; Wall finishes: wallpaper on ceiling in “Ranalegh” design (BP 1847) and paint in Stony Ground 211 in estate emulsion by Farrow & Ball; Window shade: Custom linen relaxed roman shade by Everett Design

SPECIALISTS Cabinetry installation and carpentry by H & S General Construction Quality Services; Floral services by ButterKup Flowers; Painting services provided by FRED the First Name in Home Improvement

Area 5**POWDER ROOM**

Lena Kroupnik, NCIDQ
Lena Kroupnik Interiors, LLC

RESOURCES “Russian” Sconces: Courtesy of Niermann Weeks; Sunshine gold leaf finish, crystal feathers and roping, black reversed painted backplate; Mirror: Creative Metal & Wood Inc; gold leaf antiqued finish; Table: Arteriors; Fitzgerald accent table; metal, marble; Custom Rug: Courtesy of Carpet Creations & Flooring; bound with nailhead application; Faucet: Santec; Monarch Crystal II Collection; Courtesy of Zy Kaspi; ART: Pranzo; artist Maryanne Pollock; framed by Susan Calloway Fine Arts; mixed media; ART: La Mémoire XI; Courtesy of the artist, Nurieh Mozaffari and Susan Calloway Fine Arts; Acrylic and 23k gold leaf on canvas; Key Tassel: Courtesy of Victoria Fahardo; gold chainette; handmade with semiprecious stones; Wallpaper: Courtesy of Farrow and Ball; Ocelot - BP 3704; Paint: Courtesy of Farrow and Ball; Elephant’s Breath 229. Estate Emulsion; Accessory: Gold Vase; designer’s personal collection

SPECIALISTS Wallpaper Installer/ Painter: Michael DiGuseppe; Lighting/ Plumbing Installer: James Lackford Contracting

Area 6**A COZY, CORAL FAMILY ROOM**

Kelley Proxmire
Kelley Interior Design

RESOURCES Bench: antique; Bench fabric: Hill Brown; Bench trim: Samuel and Sons; Cabinet: Michael Cleary; Cabinet Wallpaper: Thibaut; Carpet: Masland; Ceiling Wallpaper: Schumacher; Club Chairs: Pearson Co.; Club Chair fabric: Scalandre; Club Chair Trim: Kravet; Dog bed fabric: Zoffany; Floor Lamp: Visual Comfort; Floor Lamp Shade fabric: Pierre Frey; Game chairs: Kelley Proxmire; Game chair fabric: Duralee; Game chair paint: Benjamin Moore, White Dove; Grey chest: Kelley Proxmire; Overlay Rug: Dash and

Albert; Pillow fabrics: Fabricut, Schumacher, Robert Allen, Christopher Farr; Pillow trims: Samuel and Sons; Side Tables: Joss and Main; Slipper Chair fabric: Fabricut; Slipper Chair trim: Samuel and Sons; Sofa: Kelley Proxmire; Wallpaper: Farrow & Ball; White Wall Brackets: Global Views; White mirror: Kelley Proxmire; White mirror paint: Benjamin Moore White Dove; Window Treatment Fabric: Clarence House; Wing Chair fabric: Schumacher; Wing Chair trim: Samuel and Sons

SPECIALISTS Carpet Labor: Carpet Palace; Club Chair Upholstery: Pearson Co; Custom Digital effects: A.B.E. Networks; Custom Painting (game chairs, mirror): McNamara Designs; Custom Upholstery: Everett Design, Inc.; Monogrammed Napkins: Susan Steele Embroidery; Wallpaper Installation: Michael DiGuiseppa

Area 7

TERRACE

Kimberly Asner

Country Casual Teak

RESOURCES Calypso sectional in Capri: Country Casual Teak; Fiori lounge chairs in Navy w/ Oyster piping: Country Casual Teak; Calypso ottomans in Navy w/ Oyster piping: Country Casual Teak; Fiori coffee tables: Country Casual Teak; Cucina bar cart: Country Casual Teak; Studio tall planters: Country Casual Teak; Blue striped rug: Liora Manne; Teak pendant lights: Country Casual Teak; Gray striped outdoor curtains: Country Casual Teak; pillows: Country Casual Teak; Fiori candle lanterns: Country Casual Teak; Wine caddy: Country Casual Teak

Area 8

THE LIBRARY AND WHISKEY BAR

Josh Hildreth & Victor Sanz

DMG Interiors

Josh Hildreth Interiors

RESOURCES Rug by Fibreworks: natural jute with braided edge; Library wallcovering by Holland & Sherry; Jute grass cloth in Sequoia; Whiskey bar wallcovering by Farrow & Ball; "Arcade"; Paint by Farrow & Ball; "Mahogany", "Cromarty", & "French Blue"; Chandelier & sconces by McLain Wiesand; Tapestry; French Aubusson, verdure style, circa 1760; Whiskey library table; 19th century French rattan & painted chinoiserie; Sofa tables; vintage stamped Maison Jansen circa 1930-1939; Table lamps; 19th century Italian, carved alabaster urn refitted as a lamp; Lamp shades; Custom Niles & York "Nadi" with Décor De Paris trim; Sofa by Brunschwig & Fils; upholstered in Brunschwig & Fils Quillan velvet; Sofa pillow fabric by Penny Morrison; Rumeli & Anni linen with Décor De Paris trim; Pair of armless club chairs by Madina Upholstery; Custom design upholstered in Pierre Frey fabric; Throw by Swan's Island Blanket Company; Rare Wool Collection in light brown/bittersweet; Small "Duck Bill" & cocktail table by Juilian Chichester; Pair of benches by Quintus; upholstered in Moor & Giles leather and Brunschwig & Fils velvet; Peacock fure screen hand painted by Katherine Barnwell Studio; Pair of oversized bergeres by Quintus furniture; Upholstered in Moore & Giles leather; Kidney pillow fabric on bergere; Lee Jofa linen "Elidora" with Kravet Barbara Barry trim; Tea table by Mr. Brown: white gesso on wood; Stag head floor lamp by Mr. Brown; Bay window pillows: Lee Jofa "Elidora Linen", Brunschwig & Fils Panthere velvet, & Brunschwig & Fils "Streamers Ticking Stripe" with Kravet trim; Bay window curtain fabric: Brunschwig & Fils "La Portugaise" w/ Holland & Sherry trim & Niles & York ticking lining; London Shades: Tafford linen w/ custom embroidery

SPECIALISTS Art curation by Rick Robinson; Upholstery by Madina Upholstery; Wallpaper installation by International

Wall Design; Faux painting by Studio Artistica; Electrical by Fred Home Improvement; Chandelier installation by Milton's Chandelier; Antique furniture conservation by Nick Greer; Artwork installation by Artist Circle; Furniture receiving & installation by HQ Installers

Area 9

LIVING ROOM

Pamela Harvey

Pamela Harvey Interiors, LLC

RESOURCES Art: 3 Large Photographs - Floating Orchid, framed in gold frames: Fritz Gibbons Photography; Chandelier: Jacqueline by Circa Lighting; Floor Lamps: Circa Lighting; Furniture: available through Pamela Harvey Interiors; Sunburst Mirror: Lillian August; Piano: Baby Grand, Steinway; Rug: In greens - Doris Leslie Blau; Sconces: Gold with Butterflies - Tommy Mitchell; Sofa Pillows: Custom - fabric Schumacher; Window Treatments: Fabric by Schumacher; Sofas: in white Sunbrella by Hickory Chair; Sofa Pillows: Custom - fabric Schumacher

SPECIALISTS Electrical: Robert Street; Painting: Richard Schadd

Area 10

MASTER BEDROOM SUITE

Victoria Sanchez, ASID, NCIDQ, IFDA

Victoria at Home, LLC

RESOURCES All paint and wallcoverings: Farrow and Ball; Master foyer: Floorcovering: Victoria at Home; Ceiling Light: Circa; Console: Victoria at Home; Mirror over console: Kravet; Console Lamp: Victoria at Home; Accessories: Victoria at Home; Master Bedroom: Floor covering: Stark; Fabric on Upholstered Wall/Canopy: Fabricut; Fabric for Headboard & Chaise: Lee Jofa; Nightstands: Victoria at Home; Lighting: Circa; Chaise: Victoria at Home; Bench: Victoria at Home; Accessories, artwork: Victoria at Home; Master Bath: Furniture, accessories, artwork: Victoria at Home; Lighting: Circa

Area 11

BEDROOM #2

Charles C. Almonte, AIA, ASID

Charles C. Almonte Architecture Interior Design

RESOURCES Accessories: Century Furniture, American Eye, Charles C. Almonte Collection; Artwork: Merritt Gallery, Chevy Chase; Jorge Caceres, Jorge Caceres Art; Chandelier: Darlana Medium in Gilded Iron from Circa Lighting; Console Table: Ming Console in Red from Mitchell Gold; Custom Bedskirt: Duralee Fabric in Snow with Diane Von Furstenberg for tape trim from Kravet; Custom Drapery and Upholstered Headboard Fabric: Chiang Mai Dragon in Aquamarine from Schumacher; Custom Lumbar Pillows: Gifu fabric from Kravet; Drapery Hardware: Select Drapery Hardware in Brush Brass; Etagere: Silvia Etagere from Ballard Designs; Floor Lamp: Hackney Floor Table in Hand-Rubbed Antique Brass with Natural Paper Shade; Lounge Chair: Amari High Back Lounge Chair in Bamboo Green from Janus et Cie Mirror: Pillement Mirror from Schumacher; Natural Woven Shades: Horizon Window Fashions through CPDC Décor; Nightstands: Chamber Side Table in Coconut finish from Century Furniture; Paint: Green Blue 84 Farrow & Ball; Pull-up Table: Addie in Bronze from Mitchell Gold; Rug: 8'3" X 10'3" N11317 Jaipour-Traditional Rug from Doris Leslie Blau; Shams, Fitted Sheet, Flat Sheet: Harmony in Tangerine from Mitchell Gold Bob Williams; Stools: Modern

GALLERY OF DESIGN HOUSE CLASSICS



ABOUT THE DESIGNER

David Chin, is an award winning designer for “28.” With 35 years of experience in residential, corporate and retail consulting, David brings mastery and expertise to all his creative endeavors. He has an innate and intuitive sense of style. David has a capacity for organization that is natural and instinctive. Customers applaud his suggestions of design and color. His willingness to think “outside the box” brings glowing testimonials from all concerned.

David truly enjoys making his clients happy with his tasteful methods of complete home organizing.

DAVID CHIN
CLOSETS BY DESIGN

703-330-8382
closetsbydesign.com

**DESIGN HOUSE 2015
MASTER BEDROOM CLOSETS**



**DESIGN HOUSE 2014
GUEST BEDROOM TWO**

MELISSA MCLAY
MELISSA MCLAY INTERIORS

410-262-6205
melissamclayinteriors.com



**DESIGN HOUSE 2014
MASTER BATH**

CINDY GROSSMUELLER MCCLURE
**GROSSMUELLER'S DESIGN
CONSULTANTS, INC.**

202-537-0060
grossmuellers.com

Ionic Stool from Wisteria; Table Lamps: Penelope Table Lamp in Green with Natural Percale Shade from Circa Lighting; Under rug: 9X12 Seagrass from Carpet Creations; Wallpaper: Dragged Papers DR1233 Farrow & Ball; Window Shades: Natural woven window shades in Glenmont Forest through CPDC Decor

SPECIALISTS Drapery, custom bedding and window treatment workroom: CPDC Décor; Chandelier installation: Lackford Contracting; Custom headboard: Virginia Quilting; Painting: Metropolitan Decorating Inc.; Wallpaper installation: Custom Wallpaper Services

Area 12

LOFT

Steve Corbeille, Melanie Hansen & Pooja Mittra
Yardstick Interiors

RESOURCES Paint (walls): Farrow and Ball, Stiffkey Blue; Paint (ceiling): Farrow and Ball, Borrowed Light; Grasscloth (behind sofa): Schumacher, Haruki Sisal, Indigo; Grasscloth (niche): Schumacher, Feather Bloom, Two Blues; Rug: Stark, New Oriental Tibetan; Sofa: Duralee, Cardiff Sofa upholstered in Duralee pattern 36275-140; Chair: Lee Industries from American Eye 3701-01SW upholstered in Lee, Gibson Oatmeal; Ottoman: Yardstick Interiors, custom design/fabrication upholstered in Kravet Napa-50 with Kravet T30583-515 trim; Side Tables: Yardstick Interiors, custom design/fabrication upholstered in Kravet Napa-50; Writing Desk: Yardstick Interiors, custom design/fabrication, upholstered in Kravet Napa-50; Task Chair: Kravet Erin Chair upholstered in Schumacher Iconic Leopard, ink; Etageres: Bernhardt, Criteria Metal Bookcase; Console Tables: One Kings Lane, Amanda Console; Side Chairs: Stone International; Mirror = Yardstick Interiors, custom design/fabrication; Painting above sofa: Jorge Caceres, commissioned by Yardstick Interiors; Table Lamps = Arteriors Home Adler Lamps; Sconces: Arteriors Home Prescott Sconce; Draperies and Cornice: Yardstick Interiors, custom design/fabrication in Kravet 24573-50, lined in Kravet 32339-5, with Kravet T30675-8 trim; Pillows: Yardstick Interiors, custom design/fabrication; fabrics from Kravet (24573-50-5 with T30675-8), Schumacher (Iconic Leopard, ink) and Robert Allen (Sedona Ikat, indigo); Objects and Accessories from Curated Kravet, One Kings Lane, Vintage and American Eye

Area 13

VINTAGE CABANA/ROOF DECK

Quintec Hill-Mattauszek
Studio Q Designs

RESOURCES Custom One Piece Wainscoting Panels – Wainscoting America wainscotingamerica.com; Interior Wallcovering: Spoonflower www.spoonflower.com: 888-536-0002; Outdoor Fabrics: Drapery: Tommy Bahama Island Hopping, Terrasol Sunsetter Snow and Midnight; Canopy: Terrasol Sunsetter Snow; Pillows: JANUS et Cie, Billet Collins; Art & Accessories: West Elm, Etsy, Twos Company, Creative Coop, Studio Q Designs, Elk Group International; Furniture: Latitude Run, Elk Group International

SPECIALISTS Custom sectional slipcover and pillows - Hill's Interiors of Raleigh: 704-450-0134; Canopy Drapery – Paul Davis Design: 571-232-0544; Canopy Structure – Studio Q Designs: studioqdesigns.com: 301-728-2343; Custom Hand Painted Textile – Billet Collins: billetcollins.com: 301-670-5550; Deck flooring installation – Studio Q Designs: studioqdesigns.com: 301-728-2343; Graphic Design- Mattauszek Image & Design, mattauszekimageanddesign.com

Area 14

CHIC RETREAT

Barbara Brown
Barbara Brown Interiors, LLC

RESOURCES Accessories: Barbara Brown Interiors, John Rosselli & Associates, The Maryland Design Center Peyton Home; Area Rug, Stark Carpet at The Washington Design Center; Artwork: Susan Calloway Fine Arts; Bar Table: Century Furniture at The Washington Design Center; Chandelier: Niermann Weeks at J. Lambeth & Company; Desk Chair; Niermann Weeks at J. Lambeth & Company; Desk and Chinoiserie Hutch: Summerhill Cabinets; Fabrics and Trims: Schumacher at The Washington Design Center; Floor Lamps: Niermann Weeks; Gold Bench: American Eye at The Washington Design Center; Paint: Walls: Farrow & Ball #89 Luluworth Blue, Dormers: Farrow & Ball #252 Pavilion Blue; Side Table, Century Furniture at The Washington Design Center; Upholstered Furniture: American Eye at The Washington Design Center

SPECIALISTS Custom Built Chinoiserie Cabinet and Hutch: Summerhill Cabinets; Custom Built Desk with Glass Inlay: Summerhill Cabinets; Drapery Fabrication and Install: Custom Draperies Plus; Furniture Design: Barbara Brown Interiors; Hand Painted Glass on Desk and Niche: Cunningham Studios; Hand Painted Walls: Cunningham Studios; Millwork: Summerhill Cabinets; Painting: Walls Etc.; Pillow and Bench Seat Fabrication: Custom Draperies Plus; Rendering: Jane Gianarelli; Wallpaper Hanging/ Install: Walls Etc.

Area 15

DRESSING ROOM & BATH

Barbara Brown
Barbara Brown Interiors, LLC

RESOURCES Accessories: American Eye at The Washington Design Center, Barbara Brown Interiors; The Maryland Design Center Peyton Home; Artwork: Susan Calloway Fine Arts; Cigarette Table with Blue Glass: Century Furniture at The Washington Design Center; Credenza: American Eye at The Washington Design Center, Fabric and Trims: Schumacher at The Washington Design Center, Fabricut at The Washington Design Center, Duralee; Lamps: Circa Lighting; Linens: Barbara Brown Interiors; Martini tables: Century Furniture at The Washington Design Center; Mirror: Niermann Weeks at J. Lambeth, Paint: Farrow & Ball #89 Luluworth Blue Gloss; Wallpaper: Dressing, Farrow & Ball Peony BP 2303, Bath, Farrow & Ball Tessella BP 3607

SPECIALISTS Drapery Fabrication and Install: Custom Draperies Plus; Pillow Fabrication and Seat Cushions: Custom Draperies Plus; Painting: Walls Etc.; Rendering: Jane Gianarelli; Wallpaper Hanging/Install: Walls Etc.

Area 16

MADEMOISELLE CHAMBRE

Andrea Houck, ASID, IFDA
A. Houck Designs, Inc.

RESOURCES Bedroom: Ceiling Paint Farrow & Ball, Calamine; Bedroom Wall Covering: Eykon, Lavish and Lavish Swag; Bathroom Wall Covering: Eykon, Vortex; Window Treatment Fabrics: ROMO, Breathe Wild Flower; Osborne & Little, Malatya; Samuel & Sons, Lumiere fringe; Window Treatment Hardware: ONA Drapery Company, Acrylic rod with Gilded Silver French Return; Tie Backs: Hine's Showroom, Samuel & Sons, Aquarelle Single Tassel; Rug: Galleria Carpets, Elizabeth Paisley; Bed: Whiteline Modern Living, Caroline Bed; Mattress: Mattress Traditions; Side Tables: Ambella, On The

GALLERY OF DESIGN HOUSE CLASSICS



DESIGN HOUSE 2015 | KITCHEN

ABOUT THE DESIGNERS

J. Paul Lobkovich has over 25 years of experience designing acclaimed kitchens throughout the United States. His kitchens have been published in *Architectural Digest*, *Home & Design Magazine*, *Washingtonian*, *The Seattle Times*, *Home Magazine*, *Renovations Style* and *Traditional Home*. His work has also been featured on HGTV.

Emily Neifeld, a Senior Design Associate, is continually inspired by the unique challenges that each project offers. A graduate of Marymount University's Interior Design program, she is an active member of their Interior Design Advisory Board.



**J. PAUL LOBKOVICH AND
EMILY NEIFELD**

**LOBKOVICH KITCHEN
DESIGNS**

703-847-0601

Lobkovich.com



DESIGN HOUSE 2015 | BUTLER'S PANTRY



ABOUT THE DESIGNER

Established in 2000, Margery Wedderburn Interiors is a full-service interior design firm specializing in residential and hospitality design. Margery's fresh approach to design has helped establish a reputation of consistently exceeding her clients' expectations in every aspect of the project. Margery's work has been featured in many books and publications including *Spectacular Homes of Washington DC*, *Decorator Show Houses*, *Home & Design Magazine*, and *The Washington Post*. She has also been in H&D's *Portfolio of 100 Top Designers* for the past 6 years.



**MARGERY WEDDERBURN
MARGERY WEDDERBURN
INTERIORS, LLC**

703-757-5001

margerywedderburninteriors.com

Rocks; Armoire: Oly, Tyrol Armoire; Desk: Whiteline Modern Living, Elm Large Desk; Desk Chair: Hickory Chair, Suzanne Kasler, Alexandra Side Chair; Bulletin Board: Fabric, Society6; Fabrication, A. Houck Designs; Lounge Chair: Miss Pixie's, Monarch Chair; Footstool: E.J. Victor, Kelly Wearstler Footstool; Side Table: Currey & Company Princess Drinks Table, Rose; Slip Cover Fabric for Ottomans: ROMO, Chromia Multi; Lee Jofa, Shoridge Berry; Kravet, Sarasota Blush; Chandelier: Circa, Claret Short Pendant; Lamps for Side Tables: Tracey Glover Studio, Bocce Lamps; Lamp for Desk: Circa, Dasha Table Lamp; Floor Mirror: Best Master Furniture; Bed Accent Pillows: Designer's Guild, Christian Lacroix; Fabric for Accent Pillow and Desk Chair Peek-a-Boo Square: ROMO, Parada Peony; Artwork: Joe Case, Joecaseart.com; Artwork: Pryor Fine Art, Atlanta, Georgia 404-352-8775; Artwork: Jim Wehtje, X-ray Photography, alternativephotos.com; Accessories: Arteriors; Couture

SPECIALISTS Painting: Final Touch Productions 703-585-4044; Electrical: L&S Electric 703-237-0011; Wall Covering Installation: Marly's Superior Interior 703-237-9257; Soft Goods: Soulie's Interiors 703-280-2766; Seamstress Support: Rosa Cordozo 703-618-6251; Furniture Installation: N Route 301-330-5590; Framing: P&C Art and Framing 703-698-8452

Area 17

THE CHIC LAUNDRY ROOM

Allie Mann

Case Design/Remodeling, Inc.

RESOURCES Specialty Tile Floor and Wall: Mosaic Tile Company; Plumbing Fixtures: Kohler; Cabinetry: Crystal Cabinets; Cabinetry Hardware: Top Knobs; Counter Top: Norwood Stone/Ceasarstone; Specialty Lighting: Circa Lighting; Paint: Farrow and Ball

Area 18

THE LADY LAIR

Rachel Dougan

ViVi Interiors

RESOURCES Accessories - Barware: available through ViVi Interiors; Chinchilla throw/Adrian Landau; Glass bowls/American Eye; Artwork - Jorge Caceres, Morton Fine Art, and Martin Swift; Lighting - Bath sconces/Circa Lighting; Lounge area chandelier/Circa Lighting; Lounge area sconces/Union Hardware; Torchiere floor lamp/American Eye Fabrics: Drapery fabric/J. Lambeth; Sofa pillow fabric/Kravet; Sofa fabric: Donghia; Furniture - Bar cabinet/IKEA; Custom desk/available through ViVi Interiors; Custom TV cabinet/available through ViVi Interiors; Etager/CB2; Woolly drum stool/Kravet; Vintage cocktail table/Chairish; Wallcoverings - Bar area: Cole & Son/Kravet; Bath & dressing areas: Cole & Son/Kravet; Behind sofa: Thibaut/Duralee; RUG: Sisal/Floors on 14th; BATH HARDWARE: Vanity Faucet and Bath Hardware/THG & Union Hardware

SPECIALISTS Custom Carpentry: Kevin Smith; Countertop (bar area): R. Bratti; Decorative Painting: Billet Collins; Drapery Workroom: Gretchen Everett; Full-service home improvement company: FRED Home Improvement; Wallpaper installation: Michael DiGuisepppe; Painting: Solution Painting, Inc.

Area 19

KITCHEN/BREAKFAST ROOM

Betsy Barmat Stires, ASID-Allied
Frog Hill Designs, LLC

RESOURCES Dining Table and Seating: Thomas Moser; thosmoser.com 202-793-2606; Tree Branch Bronze Chandelier: David Iatesta; davidiatesta.com; 202-554-2910 hollyhunt.com; Carpet Runner: Stark;starkcarpet.com; 202-484-4566; Island Chandelier: Niermann Weeks; jlambeth.com; 202-646-1774; Mirror and Prints: Niermann Weeks; jlambeth.com; 202-646-1774; Lamps: Niermann Weeks; j.lambeth.com; 202-646-1774; Art: Gold Leaf Studios; goldleafstudios.com; 202-833-2440; Roman Shades: Hartmann and Forbes; jlambeth.com; 202-646-1774; Wallpaper and Paint: Farrow and Ball; farrowandball.com; 202-479-6780; Fabric on Screen: COWTAN and TOUT; cowntan.com; 202-863-8490

SPECIALISTS Custom Paint on Walls: Dieter Pluntke Decorating Inc.; Marcus Pluntke; mpluntke@yahoo.com; 703-602-2146; Wall Paper: Roger Hart Painting and Wallpapering; Roger Hart rogerh525@aol.com; 571-218-8671; Base Paint Prep: FRED; Chuck Kheil; ckhiel@schedulefred.com; 240-235-0152 Fabric on Screen: COWTAN and TOUT; cowntan.com; 202-863-8490; Atelier Draperies Inc., 301-728-1166

Area 20

SITTING ROOM

Camille Saum, ASID

Camille Saum Interior Design, LLC

RESOURCES Accessories - Hollis & Knight; Antique chair - Hollis & Knight; Area Rug - Madeleine Mitchell of Doris Leslie Blau; Artwork - Merritt Gallery; Drapery Hardware - Vesta Inc.; Fabric - S. Harris, JAB USA, Inc., J. Lambeth & Company, Hines & Co, Kravet, Rodolph, Inc.; Fireplace - Tile provided by Best Tile Rockville; Fireplace screen: Adam Curtis of Design Weld Metals & Mike Spiegel Glass Company; Mohair Throw - Abrielle Fine Linens & Lingerie; Ottomans - Beverly Furniture through Hollis & Knight; Paint - Farrow & Ball; Pedestal - Spectrum Limited; Roman Shades - Hartman & Forbes; Sculpture and custom base - Hollis & Knight; Sofa, Lounge chair, and Occasional chairs - Beverly Furniture through Hollis & Knight; Table Lamps - Hollis & Knight

SPECIALISTS Antique chair slip seat fabrication: Carlos Interiors; Artwork installation: Merritt Gallery; Decorative painting: Ali Nassari Atelier and Suz Podrasky of Podrasky Studios; Drapery fabrication: Everett Design; Furniture consignment: Hollis & Knight; Mantle fabrication: Michael Cooper of Hann & Hann; Painting: Hann & Hann; Pillow fabrication: Design Logistics; Roman shade installation: J. Lambeth & Company; Rug installation: Carpet Creations & Collage Workroom; Styling: Charlotte Safavi; Tile installation: Rohan Hutchison

Area 21

FORMAL IN THE WOODS - LOWER GARDEN

Stephen Wlodarczyk & Joshua Dean
Wheat's Lawn and Landscape

RESOURCES 'Circa' backless teak curved bench #4510-SD3: Country Casual Teak; Fountain-Girona Fountain Campania International provided by Merrifield Garden Center; Planters-Hampton Urn Campania International provided by Merrifield Garden Center; Boxwood Shrubs: Saunders Brothers; Plant Material: Foxborough Nursery & Manorview Farms; Boxwood Topiary: Merrifield Garden Center; Fall Annuals: Merrifield Garden Center

SPECIALISTS Outdoor Teak furniture: Country Casual Teak

DESIGN INSPIRATION FOUND HERE.

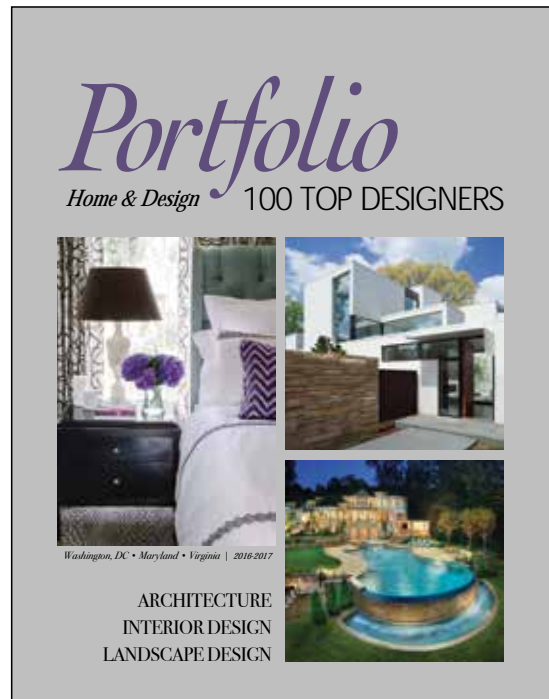
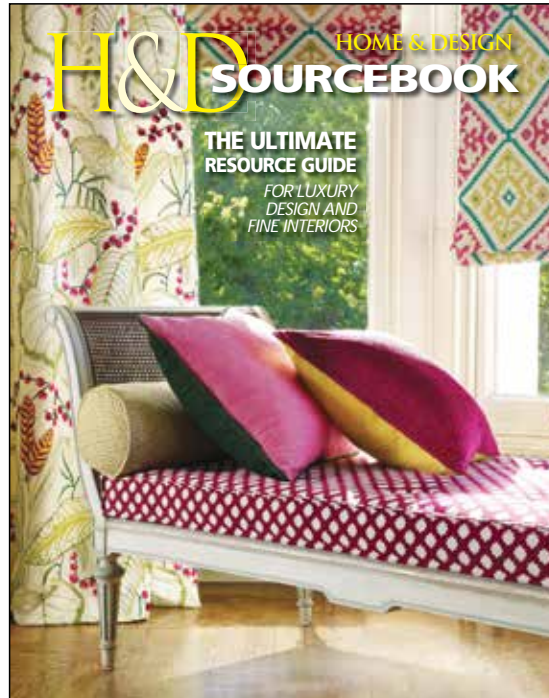
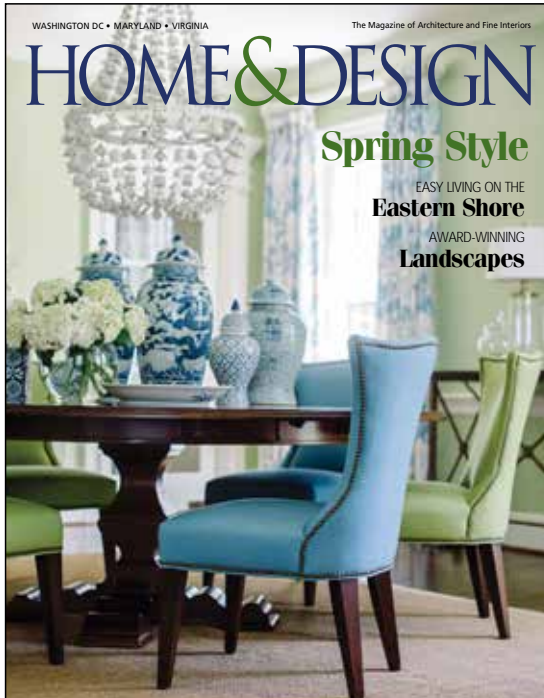

HOMESTYLES MEDIA, INC.

451 Hungerford Drive Suite 350 • Rockville, MD 20580
240-328-6275 • homeanddesign.com

TOPS FOR DESIGN

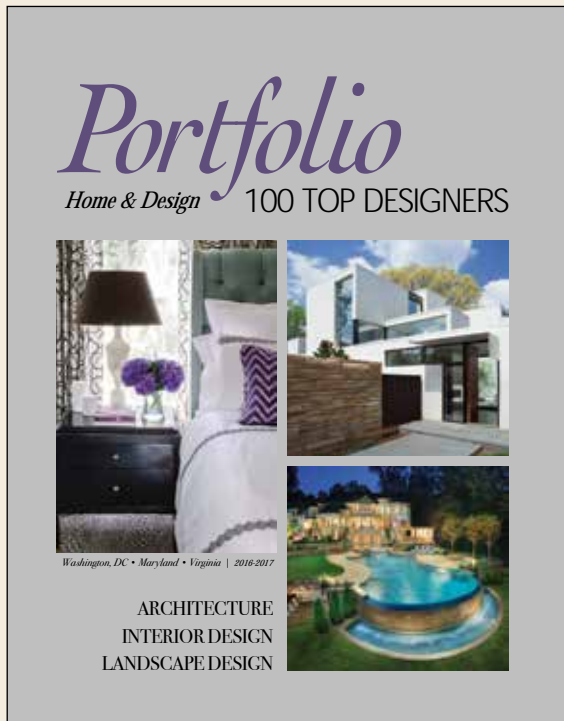

**100 Design Portfolios
From the DC Region's
Top Residential Designers**

- **Architecture**
- **Interior Design**
- **Landscape Design**

328 Pages

Over 480 Color Photos

\$15.95

**Available at Barnes & Noble
Online at HandD.com
portfolio@homeanddesign.com**

Thank You!

TO OUR ADVERTISERS & PARTNERS

| | |
|---|--------|
| A.B.E.Networks..... | 2 |
| A. Houck Designs | 4 |
| Abrielle Fine Linens & Lingerie | 30 |
| American Plant..... | 5 |
| Angie Seckinger Photography | 29 |
| Benjamin Moore | 21, 26 |
| Best Tile..... | IFC |
| Case Design/Remodeling, Inc | 19 |
| Citizens One Bank..... | 15 |
| Closets by Design..... | 6, 59 |
| Country Casual Teak..... | 1 |
| DC Living Real Estate, LLC..... | 25 |
| Dominion Electric Supply Co. | 22 |
| Eisenhower Consignment | 29 |
| Farrow & Ball | 13 |
| Ferguson Kitchen, Bath & Lighting Gallery | 10 |
| Fine Landscapes Limited..... | IBC |
| Foxcraft Design Group, Inc..... | 29, 30 |
| Fred | 25, 28 |
| GTM Architects | 35 |
| Gilday Renovations | 22 |
| Gretchen Everett | 19 |
| Grossmueller's Design Consultants, Inc..... | 59 |
| Gutierrez Studios..... | 12 |
| HOME & DESIGN Magazine | 63 |
| Hopkins & Porter | 11 |
| Kelley Interior Design..... | 21 |
| Lobkovich Kitchen Designs | 61 |
| Margery Wedderburn Interiors, LLC | 61 |
| Maryland Design Center | 28 |
| Melissa McLay Interiors | 59 |
| MoKi Media | 35 |
| Mosaic Tile | 26 |
| Naked Décor | 30 |
| Norwood Stone Corporation..... | 26 |
| Pie Sisters..... | 35 |
| Renaissance Fine Arts | 9 |
| Salvations Architectural Furnishings..... | 25 |
| Stark Carpet | 3 |
| Stuart Kitchens | BC |
| TOBE Design Group | 22 |
| Thos. Moser..... | 28 |
| Town & Country Pools, Inc..... | 8 |
| Urban Country..... | 12 |
| Washington Fine Properties | 17 |

Fine LANDSCAPES LIMITED

French Influence on the American Landscape



MAISON
WAREHOUSE

home redefined. inside & out.

MAISONWAREHOUSE.COM

(703) 421-7441

21558 STONETREE COURT
STERLING, VIRGINIA 20166

FINELANDSCAPES.COM



YOU ALWAYS KNOW A STUART KITCHEN.



SINCE 1955, WE'VE BEEN FIRST CHOICE FOR THE BEST KITCHEN IN THE NEIGHBORHOOD. COME VISIT OUR SHOWROOMS. EVERYTHING YOU NEED FOR THE ROOM YOU'LL LOVE THE MOST IS HERE IN ONE PLACE. AND, YOU'LL UNDERSTAND WHY SO MANY PEOPLE SAY, "NOTHING ADDS MORE VALUE TO YOUR HOME."

BETHESDA SHOWROOM AT 8203 WISCONSIN AVE. 240-223-0875

WWW.STUARTKITCHENS.COM